

**Dig Safely - New York**  
 Underground Facilities Protective Organization  
**800-962-7962**  
 www.digsafelynewyork.org

Call Before You Dig  
 Wait The Required Time  
 Confirm Utility Response  
 Respect the Marks  
 Dig With Care

CONSTRUCTION NOTES

ALL WORK SHALL BE ACCOMPLISHED ACCORDING TO THE PLANS AND SPECIFICATIONS OF THE PROJECT. ANY CHANGES SHALL BE WITH PRIOR WRITTEN APPROVAL BY THE ENGINEER AND/OR CONTRACTING OFFICER.

AT LEAST TWO FULL WORKING DAYS PRIOR TO EXCAVATION, THE CONTRACTOR SHALL NOTIFY THE UNDERGROUND FACILITIES PROTECTION ORGANIZATION (U.F.P.O.) AT 1-800-962-7962 AND ANY OTHER LOCAL UTILITIES THAT MAY BE IN THE AREA.

THE CONTRACTOR SHALL GIVE THE DCSWCD AND THE LANDOWNER/OPERATOR A MINIMUM OF TWO FULL WORKING DAYS NOTICE PRIOR TO CONSTRUCTION.

ALL CONSTRUCTION PRACTICES SHALL BE IN ACCORDANCE WITH O.S.H.A. STANDARDS AND REGULATIONS PART 1910 AND 1926. ALL TRENCH EXCAVATIONS IN UNSTABLE SOILS OR IN TRENCHES GREATER THAN FIVE FEET DEEP SHALL BE SLOPED, SHORED, OR SHIELDED ACCORDING TO O.S.H.A. PART 1926.

I HAVE REVIEWED THE DRAWINGS AND SPECIFICATIONS FOR THIS PROJECT. THE PROJECT HAS BEEN EXPLAINED TO ME FULLY, AND I AGREE WITH ALL TECHNICAL ASPECTS OF THE PROJECT.

LANDOWNERS SIGNATURE: \_\_\_\_\_ DATE: \_\_\_\_\_

Stream Corridor Management Program  
 Delaware Co. SWCD  
 Rama/Lutz  
 Streambank Stabilization

CONTENTS

- Sheet 1 : Title Sheet
- Sheet 2: Existing Plan View
- Sheet 3: Proposed Plan View
- Sheet 4: Construction Plan
- Sheet 5: Existing Profile
- Sheet 6: Cross Sections-Sta. 0+00 to 1+50
- Sheet 7: Cross Sections-Sta. 2+00 to 3+50
- Sheet 8: Cross Sections-Sta. 4+00 to 4+58
- Sheet 9: Cross Sections-Sta. 5+00 to 6+00
- Sheet 10: Cross Sections-Sta. 6+50 to 8+00
- Sheet 11: Cross Sections-Sta. 8+50 to 9+79
- Sheet 12: Cross Sections-Sta. 10+00 to 10+50
- Sheet 13: Detail Sheet

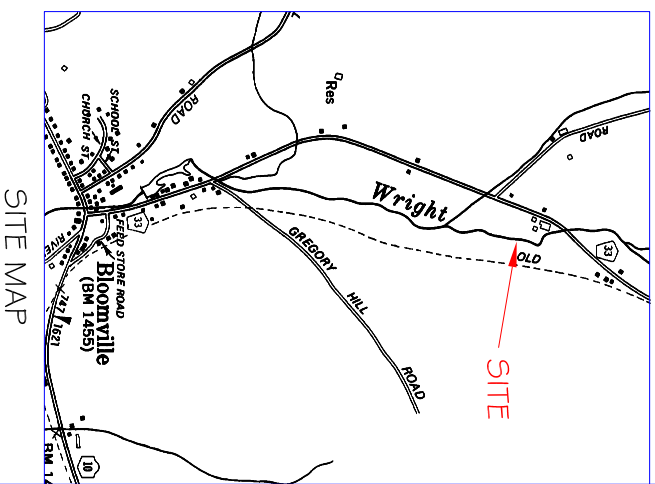

Rama/Lutz Streambank Stabilization	
Title Sheet	
Delaware Co. Stream Corridor Management Program Delaware Co., NY	
Delaware County Soil & Water Conservation District 44 West Street Walton, NY 13856	
Designed	T.M.
Drawn	J.M.F.
Traced	_____
Checked	_____
Approved by	_____
Title	_____
Title	_____
Sheet	_____
Drawing No.	DE-C-SCMP-006

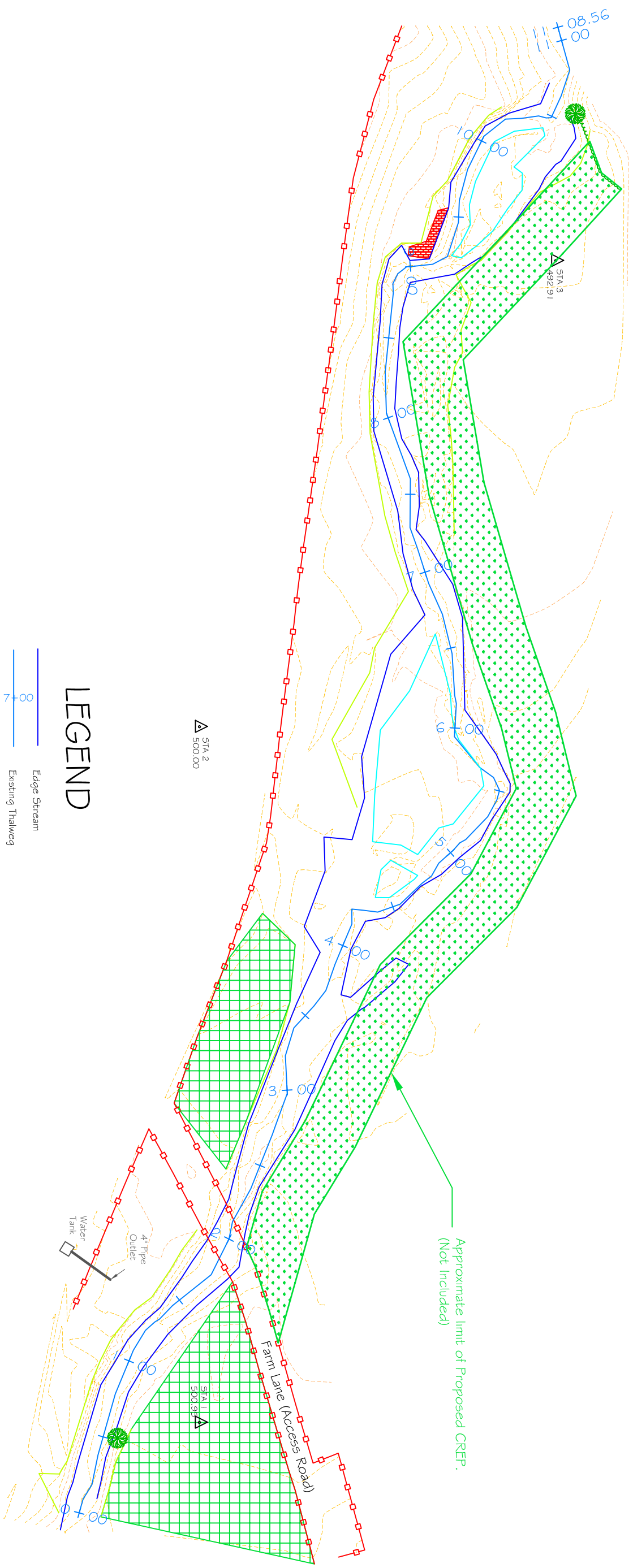

Approximate limit of Proposed CREP.  
(Not Included)

# LEGEND



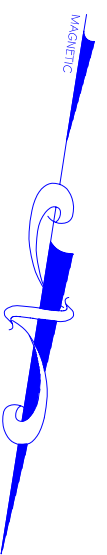



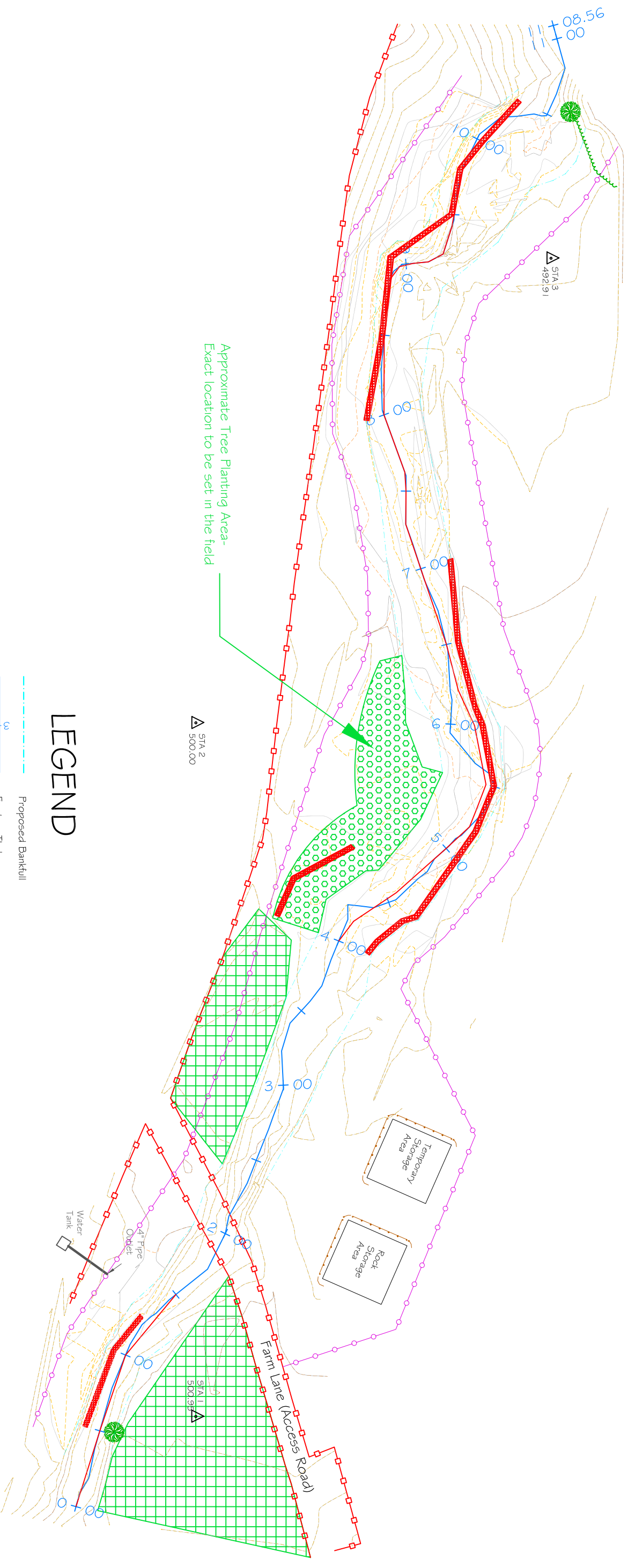





- Edge Stream
- Existing Thalweg
- Center Bar/Island
- Treeline
- Existing Fence
- Major Contour (Existing)
- Minor Contour (Existing)
- Existing Rip Rap
- Proposed CREP Limit (N.I.C.)
- Existing CREP
- Survey Control Point



Rama/Lutz Streambank Stabilization Existing Plan View Delaware Co. Stream Corridor Management Program Delaware Co., NY Delaware County Soil & Water Conservation District 44 West Street Walton, NY 13856			
Designed by	TJM	Date	12.05
Drawn by	JMF	Title	
Traced by		Sheet	
Checked by		Drawing No.	DE-C-SCWP-006



# LEGEND

-  Proposed Bankfull
-  Existing Thaliweg
-  Proposed Thaliweg
-  Existing Fence
-  Proposed Fence
-  Major Contour (Proposed)
-  Minor Contour (Proposed)
-  Major Contour (Existing)
-  Minor Contour (Existing)
-  Existing CREP
-  Proposed Tree Planting
-  Proposed Toe Rock

 Survey Control Point



<p>Rama/Lutz Streambank Stabilization Proposed Plan View Delaware Co. Stream Corridor Management Program Delaware Co., NY</p>	
<p>Designed by: TIM Drawn by: JMF Title: _____ Date: 12-05</p>	
<p>Approved by: _____ Title: _____ Date: _____</p>	
<p>Delaware County Soil &amp; Water Conservation District 44 West Street Walton, NY 13856</p>	
<p>Sheet No. _____ of _____</p>	<p>Drawing No. DE-C-SCMP-006</p>

**SEQUENCE OF OPERATIONS**

**I. Mobilization & Preliminary Operations**

- A. Install temporary fence.
- B. Construct Rock Storage Area and Temporary Storage Area.
- C. Construct filter fence at both storage areas.
- D. Place any stripped topsoil in the Temporary Storage Area.
- E. Place any other earthwork material in the Temporary Storage Area; keep it separate from the topsoil.

**II. Work at 0+00 +/- to 1+50 +/-**

- A. Construct coffer dam and install pumps at 0+25 +/-.
- B. Install hose(s) and pump water to 1+75 +/-.
- C. Construct rip-rap from 0+50 L/T to 1+30 L/T.
- D. Construct floodplain; including seeding, mulching, and erosion control material
- E. Remove coffer dam, hoses and pumps.

**III. Work at 3+00 +/- to 8+00 +/-**

- A. Construct coffer dam and install pumps at 3+25 +/-.
- B. Install hoses and pump water to 8+25 +/-.
- C. Grade channel and banks to the elevations as shown on the plans and cross-sections. Store any excess material in the Temporary Storage Area.
- D. Construct rip-rap at the locations and elevations as shown on the plans and cross-sections.
- E. Construct floodplain; including seeding, mulching, and erosion control material
- F. Remove coffer dam, hoses and pumps.

**IV. Work at 7+00 +/- to 10+50 +/-**

- A. Construct coffer dam and pumps at 6+75 +/-.
- B. Install hoses and pump water to 10+50 +/-.
- C. Grade channel and banks to the elevations as shown on the plans and cross-sections. Store any excess material in the Temporary Storage Area.
- D. Construct rip-rap at the locations and elevations as shown on the plans and cross-sections.
- E. Construct floodplain; including seeding, mulching, and erosion control material
- F. Remove coffer dam, hoses and pumps.

**V. Seeding & Planting**

- A. Seed and mulch all disturbed areas in accordance with the plans and specifications.
- B. Install plantings in accordance with the plans and specifications.

**VI. Cleanup and Demobilization**

- A. Remove filter fence, clean up storage areas, including seeding, mulching and regrading if required.
- B. Remove all equipment, tools, and unused materials from site.

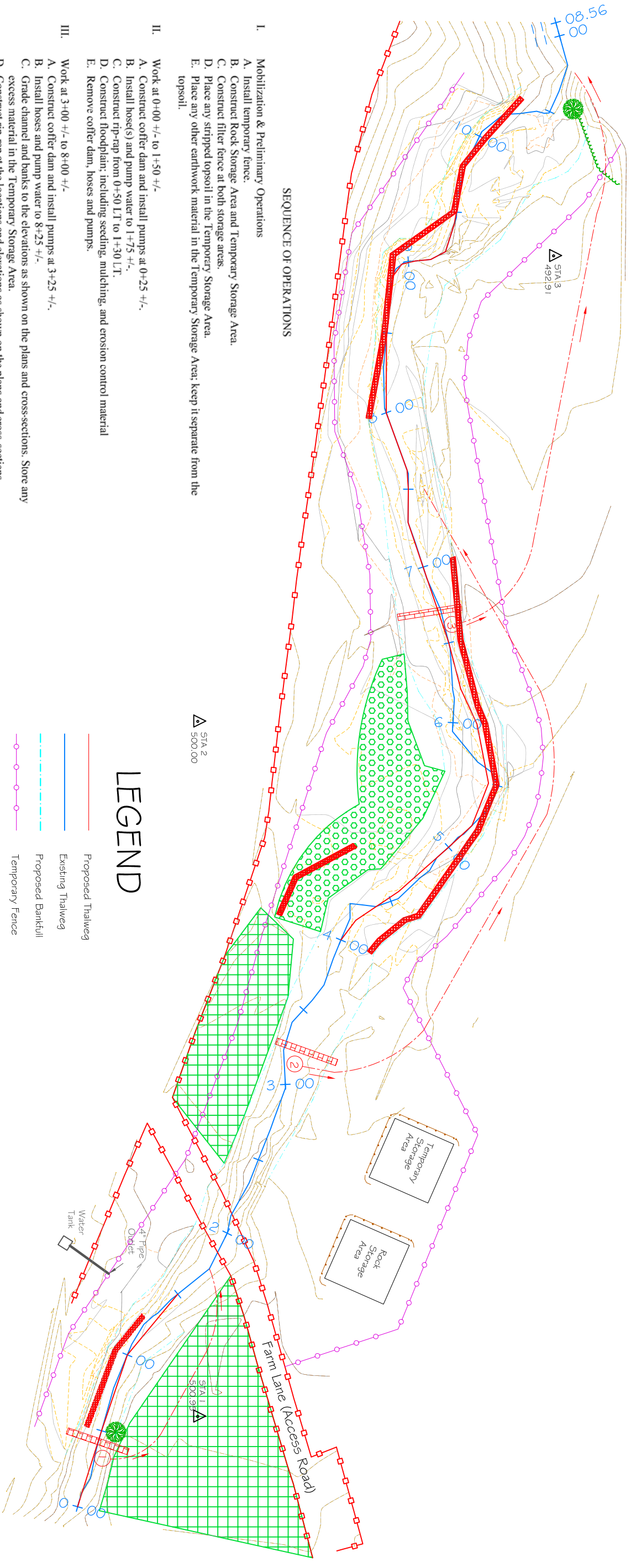

**LEGEND**

- Proposed Thailweg
- Existing Thailweg
- Proposed Bankfill
- Temporary Fence
- Existing Fence
- Silt Fence
- Coffer Dam and Pump
- Existing CREP
- Proposed Tree Planting
- Proposed Toe Rock
- Survey Control Point

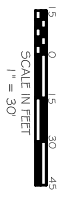
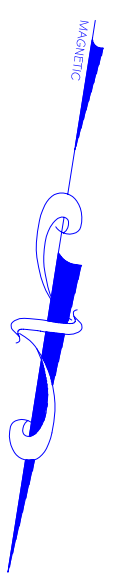

RamalLutz Streambank Stabilization Construction Plan Delaware Co. Stream Corridor Management Program Delaware Co., NY Delaware County Soil & Water Conservation District 44 West Street Walton, NY 13856		Designed By: JMI Date: 12-05 Title: 12-05 Drawn: JMF Title: 12-05 Checked: _____ Date: _____	Approved By: _____ Title: _____ Date: _____ Sheet: _____ Drawing No: DE-C-SCNPF-006 of: 11
---	--	--	---



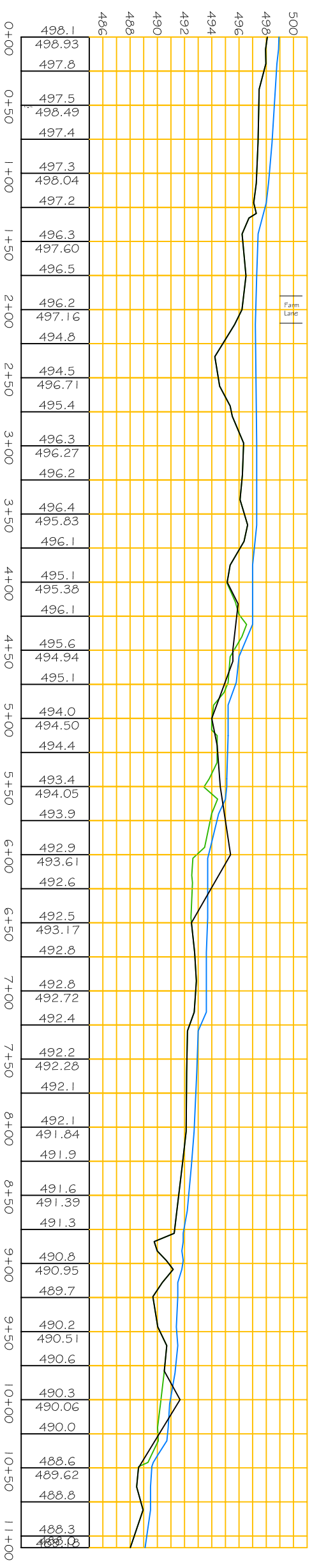

# LEGEND

- Existing Ground
- Existing Water Surface



RamalLutz Streambank Stabilization Thruway Profile Delaware Co. Stream Corridor Management Program Delaware Co., NY Delaware County Soil & Water Conservation District 44 West Street Walton, NY 13656		Designated: <u>T.M.</u> Date: <u>12-05</u> Drawn: <u>J.M.F.</u> Title: _____ Sheet No. <u>3</u> of <u>11</u>	Approved by: _____ Title: _____ Drawing No.: <u>DE-C-SQMF-006</u>
Checked:			

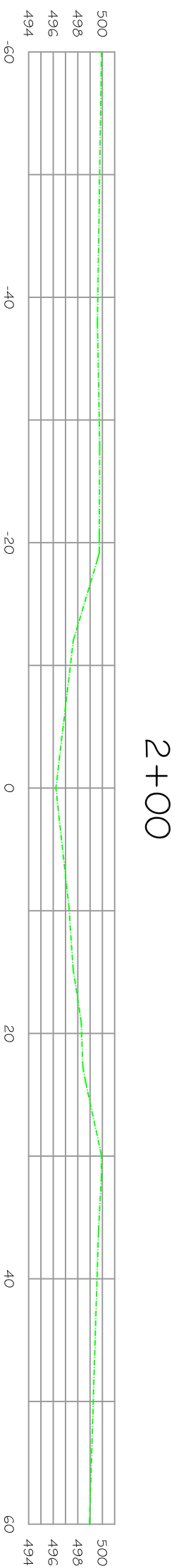

2+00

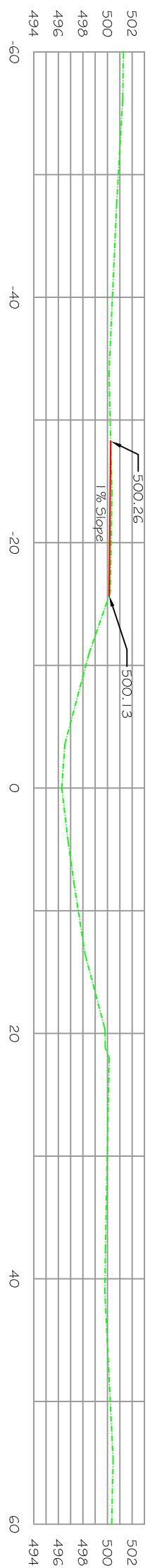

1+50

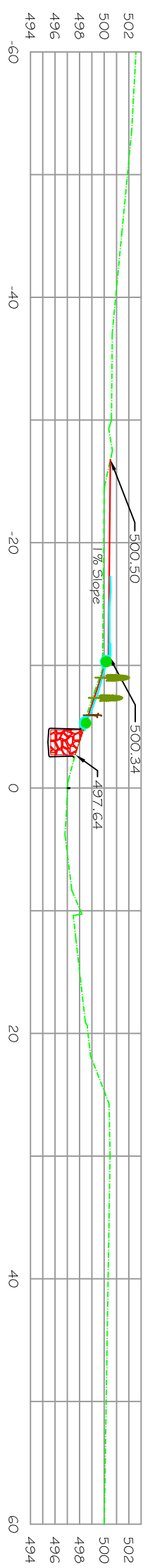

1+25

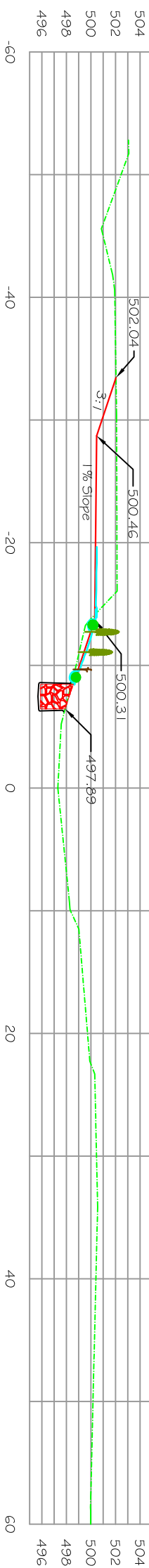

1+00

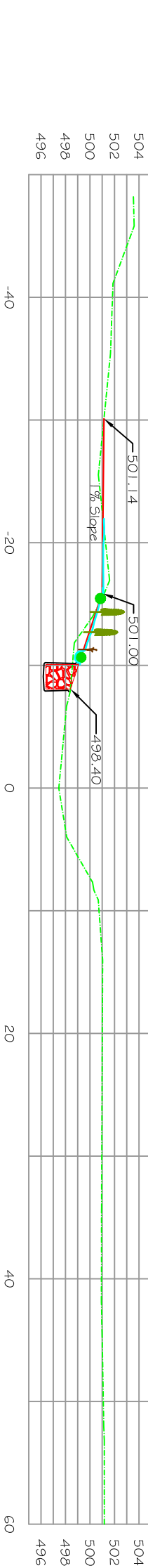

0+50

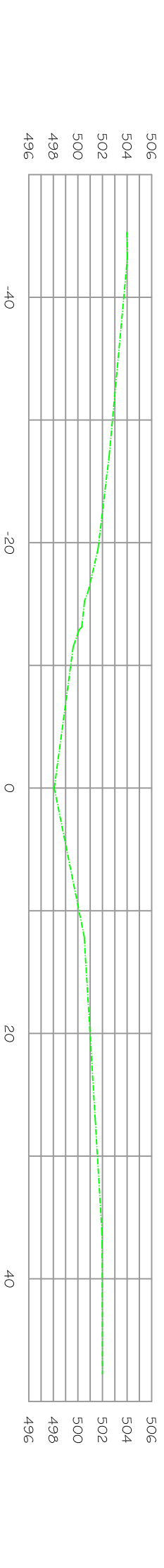

0+00

- LEGEND**
- - - Existing Ground
  - Proposed Ground
  - Proposed Med-Stone Fill
  - Erosion Control Mat
  - Geotextile
  - Shrub
  - Sedge
  - Fascine

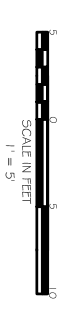

<b>Rama/Lutz</b> Streambank Stabilization Cross Sections-Sta. 0+00 to 2+00 Delaware Co. Stream Corridor Management Program Delaware Co., NY Delaware County Soil & Water Conservation District 44 West Street Walton, NY 13856			
Designed by	TJM	Scale	1:2.05
Drawn by	JMF	Title	
Traced by		Sheet No.	
Checked by		Drawing No.	DE-C-SCMP-006

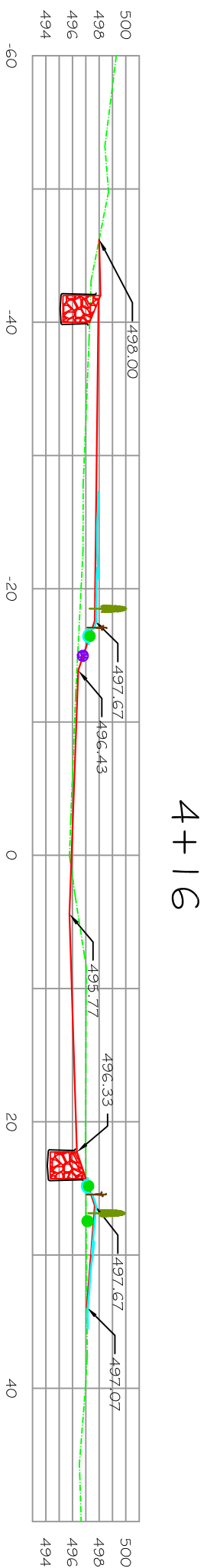

4+16

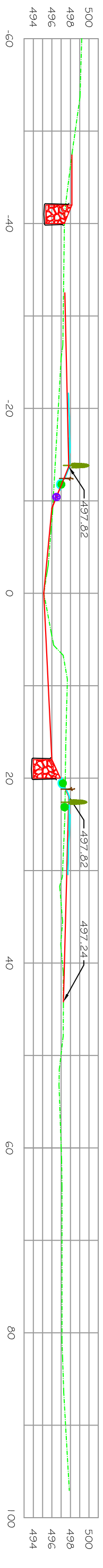

3+50

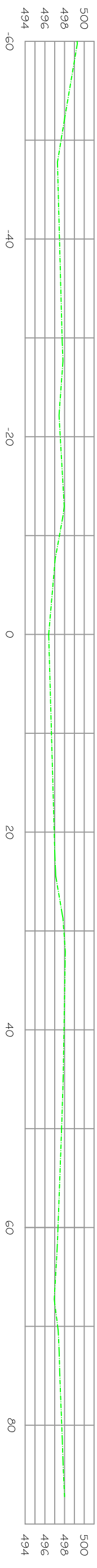



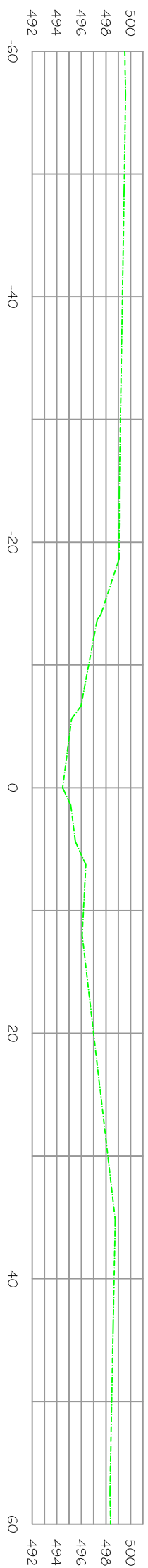





3+00



2+50

## LEGEND

- |   |                          |   |            |
|---|--------------------------|---|------------|
|  | Existing Ground          |  | Geotextile |
|  | Proposed Ground          |  | Shrub      |
|  | Proposed Med. Stone Fill |  | Sedge      |
|  | Erosion Control Mat      |  | Fascine    |
|   |                          |  | Coir Log   |

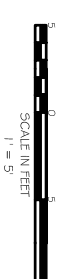

Ramal/Lutz Streambank Stabilization Cross Sections-5+1a, 2+50 to 4+16 Delaware Co. Stream Corridor Management Program Delaware Co., NY Delaware County Soil & Water Conservation District 44 West Street Walton, NY 13856			
Designed by	TJM	Date	12-05
Drawn by	JMF	Title	
Traced by		Sheet No.	
Checked by		Drawing No.	DE-C-SCMP-006

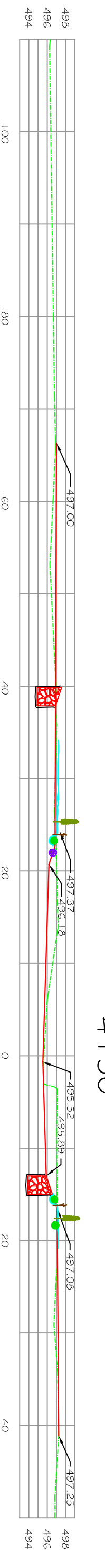
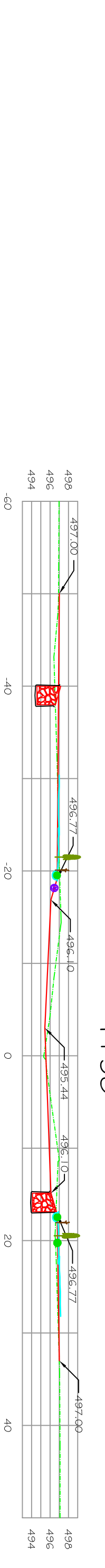
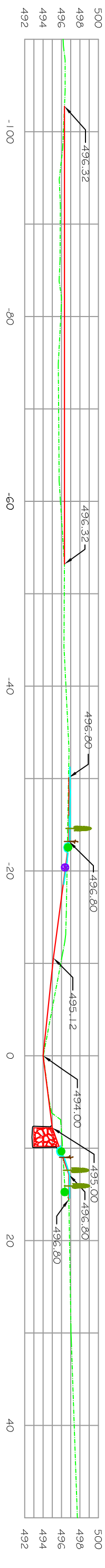
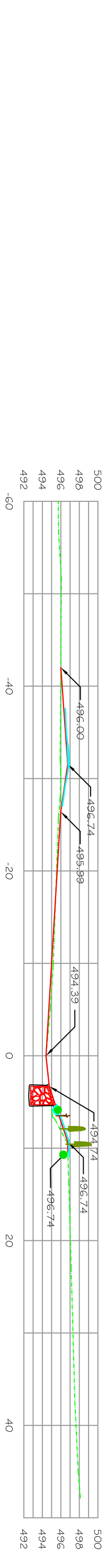
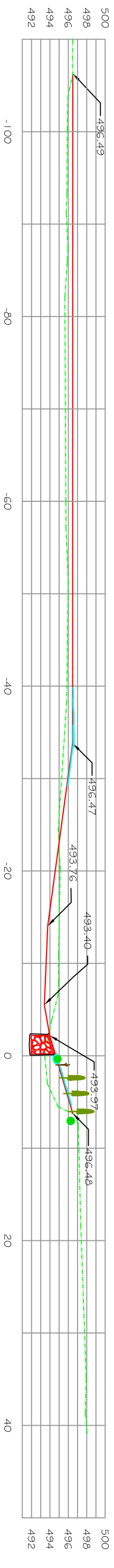

# LEGEND

- - - Existing Ground
- Proposed Ground
- Proposed Med./Stone Fill
- Erosion Control Mat
- Geotextile
- Shrub
- Sedge
- Fascine
- Corr Log



<p style="text-align: center;"><b>Rama/Lutz</b></p> <p style="text-align: center;">Streambank Stabilization Cross Sections-51a, 4+50 to 5+50 Delaware Co. Stream Corridor Management Program Delaware Co., NY</p> <p style="text-align: center;">Delaware County Soil &amp; Water Conservation District 44 West Street Walton, NY 13856</p>		Designer <b>TJM</b>	Title 12-05
Drawn <b>JMF</b>	Title _____	Checked _____	Sheet _____
Traced _____	Title _____	of 111 _____	Drawing No. <b>DE-C-SCMP-006</b>



# 8+00

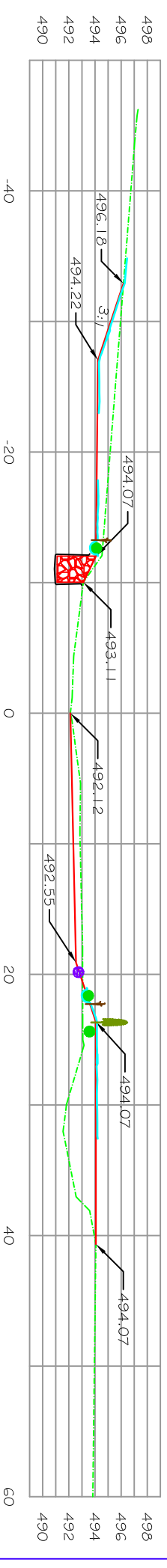

# 7+50

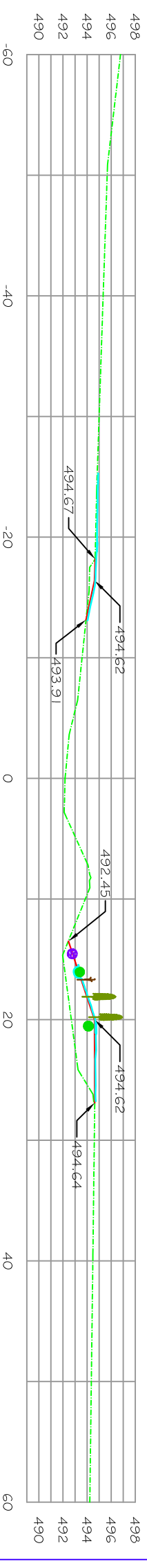

# 7+00

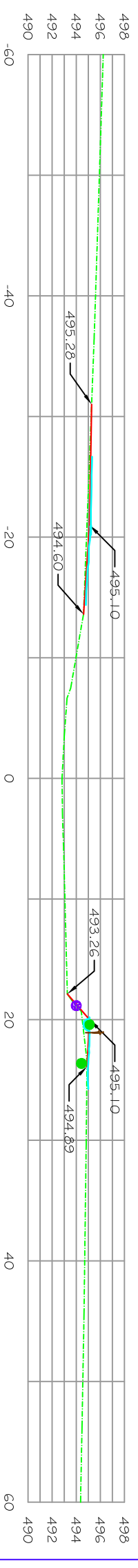

# 6+50

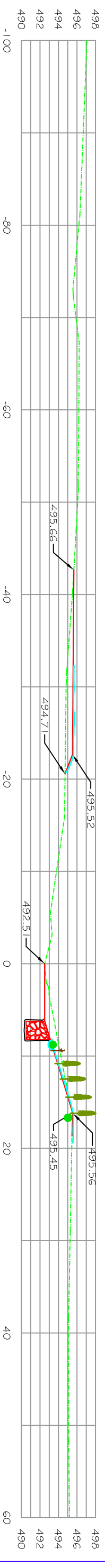

# 6+00

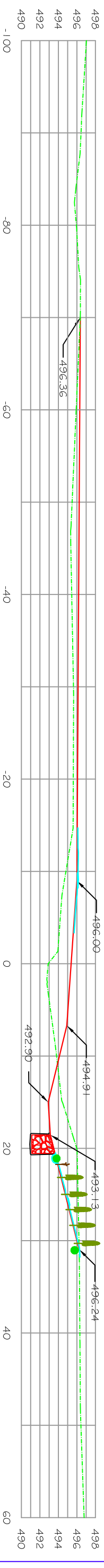

## LEGEND

- Existing Ground
- Proposed Ground
- Proposed Med. Stone Fill
- Erosion Control Mat
- Geotextile
- Shrub
- Sedge
- Fascine
- Cor. Log

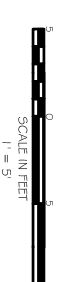

Ramal/Lutz Streambank Stabilization Cross Sections-5ft. 6+00 to 8+00 Delaware Co. Stream Corridor Management Program Delaware County Soil & Water Conservation District 44 West Street Walton, NY 13856	
Designed by	TJM
Drawn by	JMF
Traced by	
Checked by	
Scale	1" = 5'
Sheet No.	DF-C-SCMP-006
Drawing No.	
Approved by	
Title	

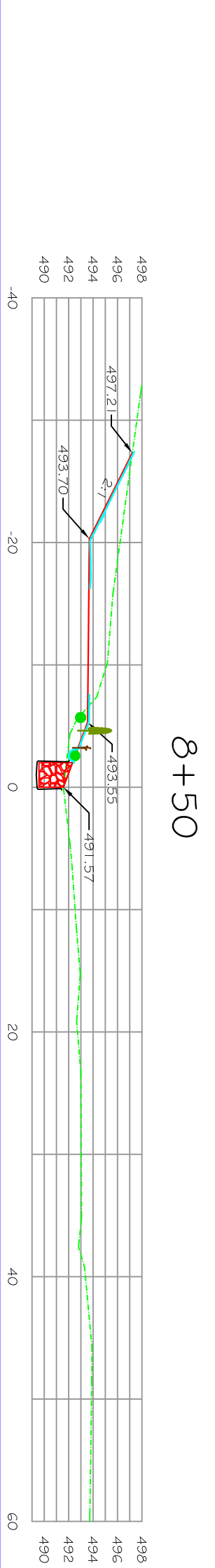
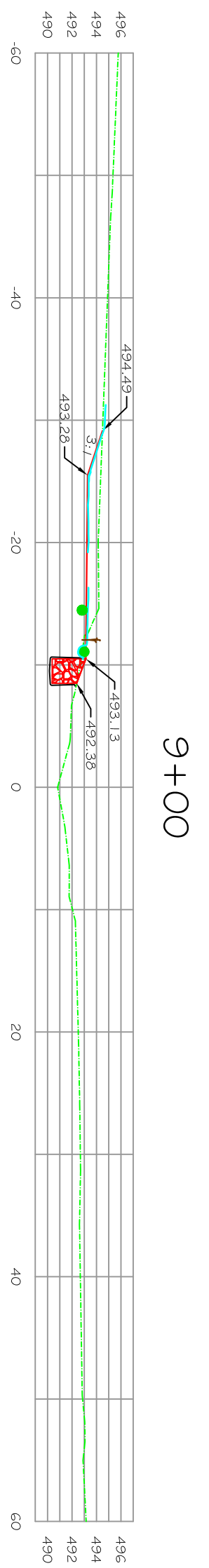
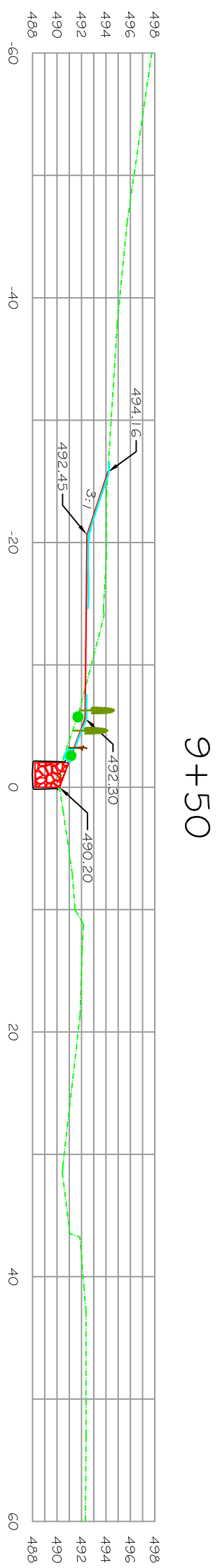
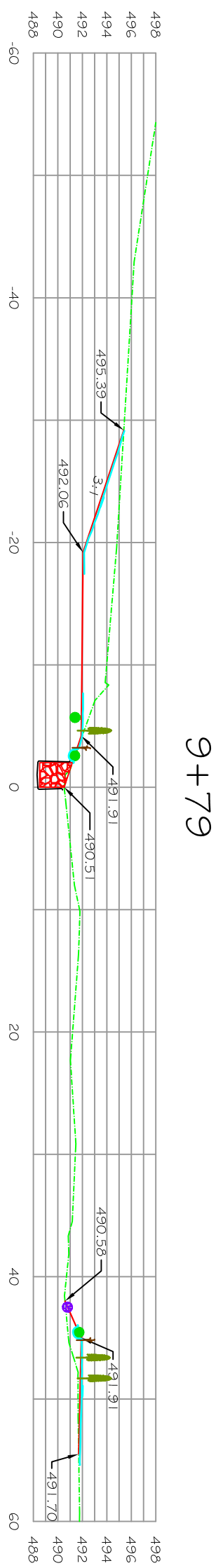
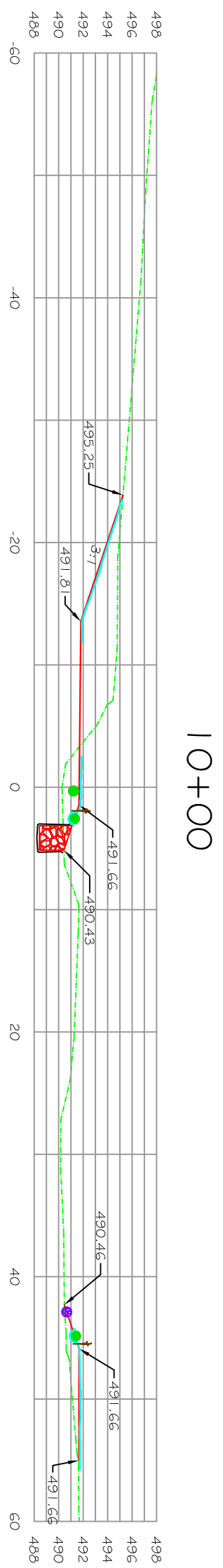
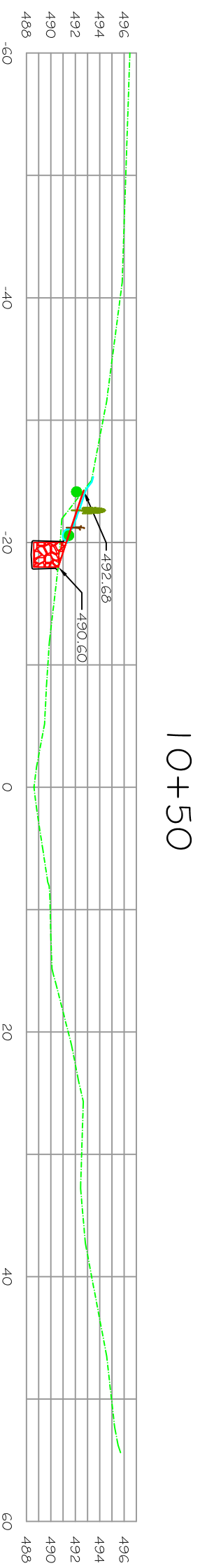

- ### LEGEND
- - - Existing Ground
  - Proposed Ground
  - ▨ Proposed Med. Stone Fill
  - Erosion Control Mat
  - Geotextile
  - Shrub
  - | Sedge
  - Fascine
  - Corr Log



<b>Rama/Lutz</b>	
Streambank Stabilization	
Cross Sections-Sta. 8+50 to 10+50	
Delaware Co. Stream Corridor Management Program	
Delaware Co., NY	
Delaware County Soil & Water Conservation District	
44 West Street	
Walton, NY 13856	
Designed by TJM	Title
Drawn by JMF	12-05
Traced by	
Checked by	
Sheet No. Drawing No. DF-C-5CMP-006	

## Corr Log Installation Detail

Plan View  
(Not to Scale)

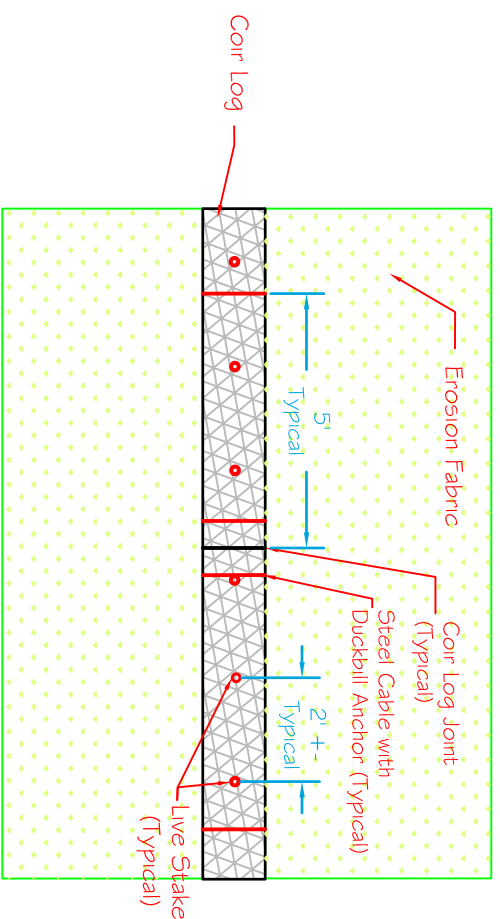

Notes: Minor earthwork to be conducted by hand to ensure tight fit. Seed and plant when anchored.

D:\land Project\K3\DOT Files\Stream\Typical\Stream Program\corlogplan.dwg

## Corr Log Installation Detail

Section View  
(Not to Scale)

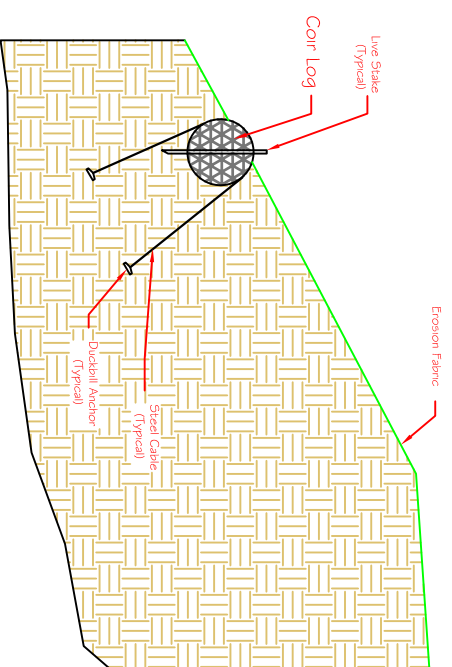

Notes: Minor earthwork to be conducted by hand to ensure tight fit. Seed and plant when anchored.

D:\land Project\K3\DOT Files\Stream\Typical\Stream Program\corlogsection.dwg

## Coffer Dam Detail

(Not to Scale)

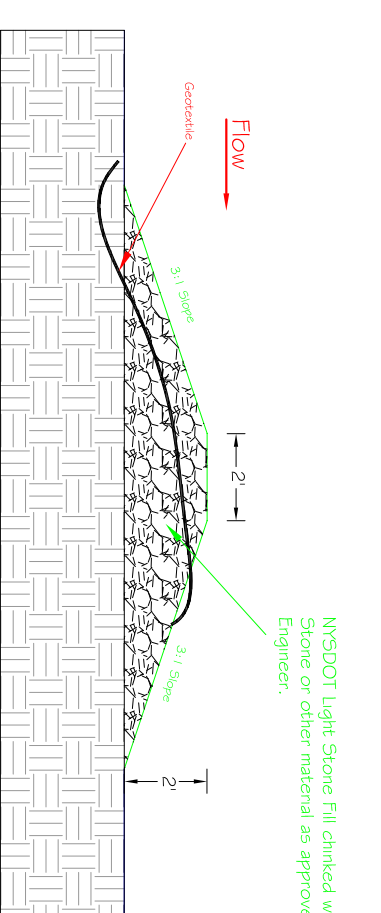

NYSDDOT Light Stone Fill chinked with #2 Stone or other material as approved by the Engineer.

D:\land Project\K3\DOT Files\Stream\Typical\Stream Program\CofferDam.dwg

## Bank Stabilization Detail

(Not to Scale)

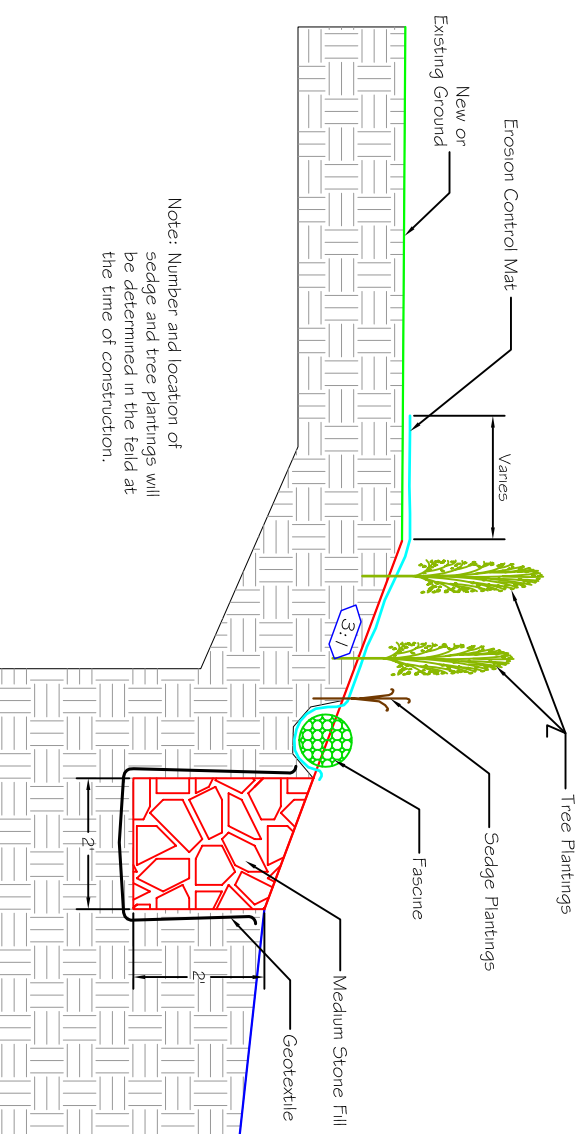

Note: Number and location of sedge and tree plantings will be determined in the field at the time of construction.

D:\MDT Files\Typical\Bank\_Details\dwg\Rama-Lutz\_Bank\_2

## Live Fascine Detail

(Not to Scale)

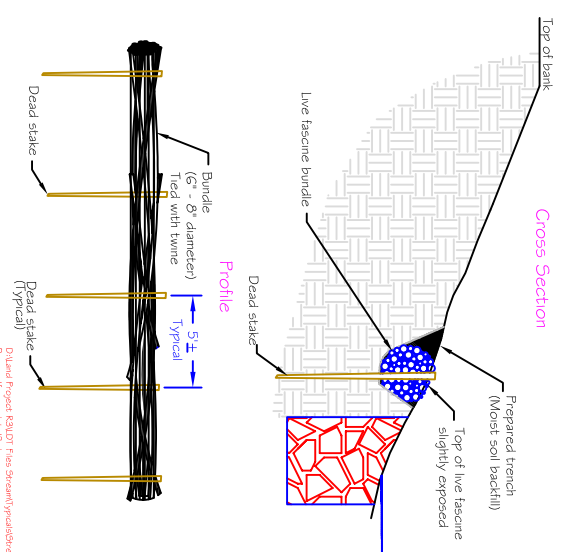

D:\land Project\K3\DOT Files\Stream\Typical\Stream Program\livefascine.dwg

## Silt Fence Details

(Not to Scale)

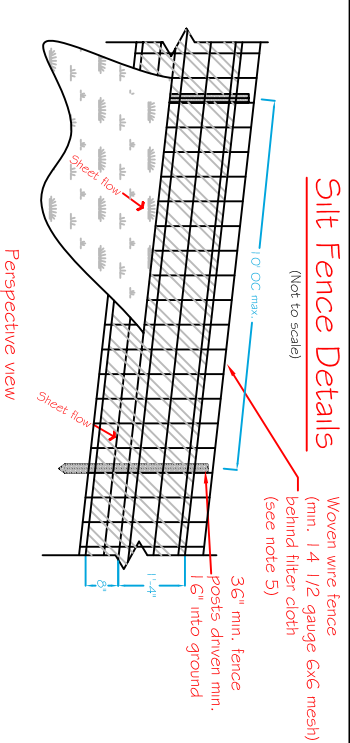

Woven wire fence (min. 1 1/2 gauge 6x6 mesh) behind filter cloth (see note 5)

3/4" min. fence posts driven min. 1'-4" into ground

Filter cloth: Filter X, Mirafi 100X, Stablinka T1 40N or approved equal

Pre-fabricated unit: Geotab, Envirofence, or approved equal

Embed filter cloth 1'-4" into ground

Sheet flow

Sheet flow

Sheet flow

Sheet flow

Cross section view

1. Woven wire fence to be fastened securely to fence posts with wire ties or staples.
2. Filter cloth to be fastened securely to woven wire fence with ties spaced every 24" at top and mid section.
3. When two sections of filter cloth adjoin each other they shall be overlapped by six inches and folded.
4. Maintenance shall be performed as needed and material removed when "bulges" develop in the silt fence.
5. Pre-fabricated units do not require the use of woven wire fence.

Rama/Lutz Streambank Stabilization Detail Sheet	
Delaware Co. Stream Corridor Management Program Delaware Co., NY	
Delaware County Soil & Water Conservation District 44 West Street Walton, NY 13856	
Designed by TJM	Drawn by JMF
Checked by TJM	Traced by JMF
Approved by TJM	Title TJM
Scale 1:2.05	Sheet DF-C-SCMP-006