

Dig Safely - New York
 Underground Facilities Protective Organization
800-962-7962
 www.digsafelynewyork.org

Call Before You Dig
 Wait The Required Time
 Confirm Utility Response
 Respect the Marks
 Dig With Care

CONSTRUCTION NOTES

ALL WORK SHALL BE ACCOMPLISHED ACCORDING TO THE PLANS AND SPECIFICATIONS OF THE PROJECT. ANY CHANGES SHALL BE WITH PRIOR WRITTEN APPROVAL BY THE ENGINEER AND/OR CONTRACTING OFFICER.

AT LEAST TWO FULL WORKING DAYS PRIOR TO EXCAVATION, THE CONTRACTOR SHALL NOTIFY THE UNDERGROUND FACILITIES PROTECTION ORGANIZATION (U.F.P.O.) AT 1-800-962-7962 AND ANY OTHER LOCAL UTILITIES THAT MAY BE IN THE AREA.

THE CONTRACTOR SHALL GIVE THE DCSWCD AND THE LANDOWNER/OPERATOR A MINIMUM OF TWO FULL WORKING DAYS NOTICE PRIOR TO CONSTRUCTION.

ALL CONSTRUCTION PRACTICES SHALL BE IN ACCORDANCE WITH O.S.H.A. STANDARDS AND REGULATIONS PART 1910 AND 1926. ALL TRENCH EXCAVATIONS IN UNSTABLE SOILS OR IN TRENCHES GREATER THAN FIVE FEET DEEP SHALL BE SLOPED, SHORED, OR SHIELDED ACCORDING TO O.S.H.A. PART 1926.

I HAVE REVIEWED THE DRAWINGS AND SPECIFICATIONS FOR THIS PROJECT. THE PROJECT HAS BEEN EXPLAINED TO ME FULLY, AND I AGREE WITH ALL TECHNICAL ASPECTS OF THE PROJECT.

LANDOWNERS SIGNATURE: _____ DATE: _____

Stream Corridor Management Program
 Delaware Co. SWCD
 Rama/Lutz
 Streambank Stabilization

CONTENTS

- Sheet 1 : Title Sheet
- Sheet 2: Existing Plan View
- Sheet 3: Proposed Plan View
- Sheet 4: Construction Plan
- Sheet 5: Existing Profile
- Sheet 6: Cross Sections-Sta. 0+00 to 1+50
- Sheet 7: Cross Sections-Sta. 2+00 to 3+50
- Sheet 8: Cross Sections-Sta. 4+00 to 4+58
- Sheet 9: Cross Sections-Sta. 5+00 to 6+00
- Sheet 10: Cross Sections-Sta. 6+50 to 8+00
- Sheet 11: Cross Sections-Sta. 8+50 to 9+79
- Sheet 12: Cross Sections-Sta. 10+00 to 10+50
- Sheet 13: Detail Sheet

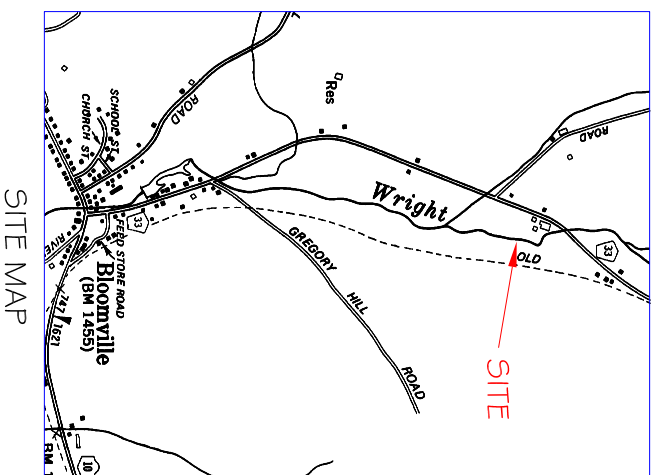

Rama/Lutz Streambank Stabilization	
Title Sheet	
Delaware Co. Stream Corridor Management Program Delaware Co., NY	
Delaware County Soil & Water Conservation District 44 West Street Walton, NY 13856	
Designed	T.M.
Drawn	J.M.F.
Traced	_____
Checked	_____
Approved by	_____
Title	12-05
Title	_____
Sheet	_____
Drawing No.	DE-C-SCMP-006

Existing Plan View (As-built)

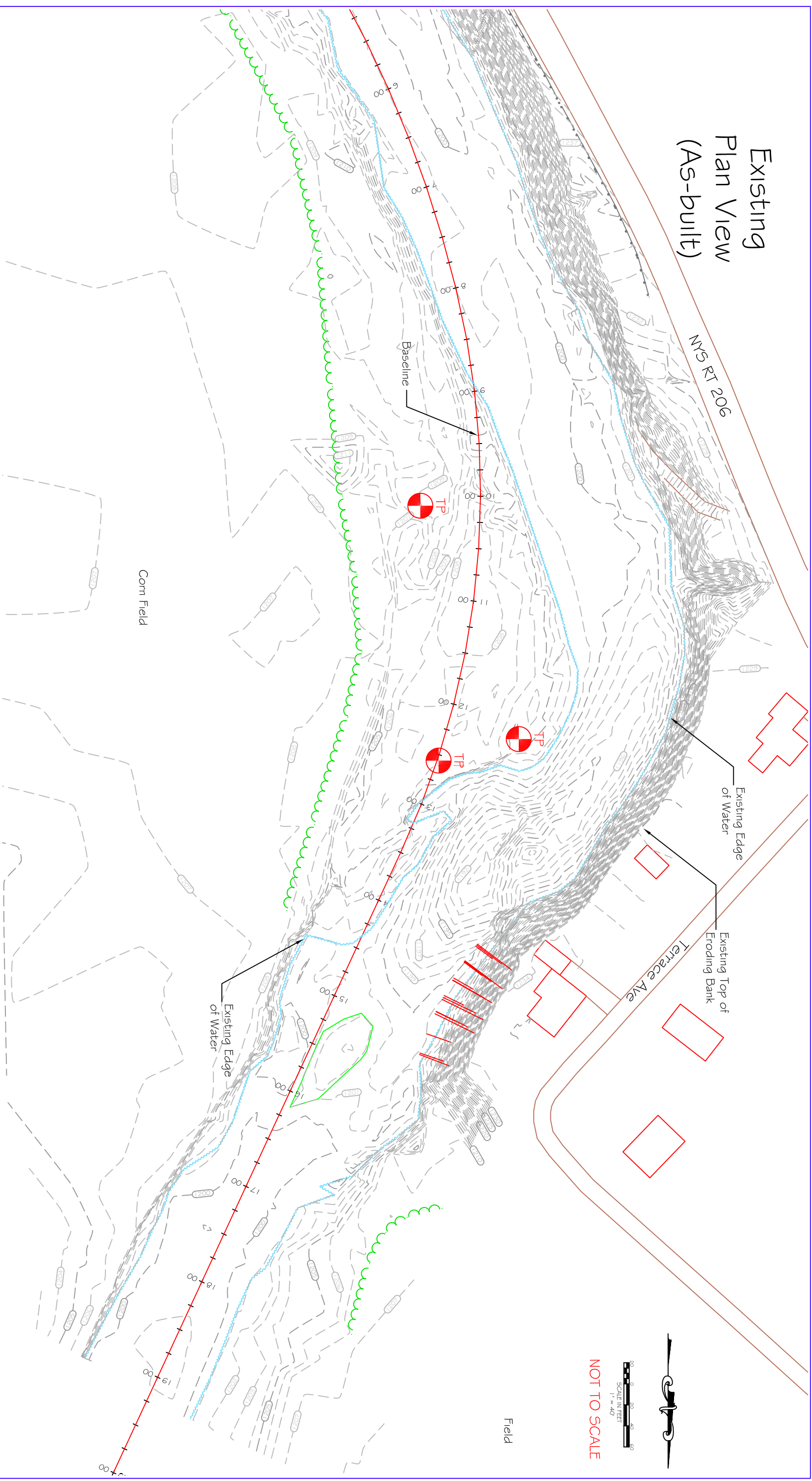

LEGEND

- Existing Contour
- Major Existing Contour
- Minor Existing Contour
- Gutterrail
- Edge of Roadway
- Treeline
- Building
- Edge of Water

30 0 30 40 60
SCALE IN FEET
1" = 40'

NOT TO SCALE

Terrace Avenue As-built	
WBDR Restoration	
Existing Planview	
Delaware Co. Stream Corridor Management Program	
Delaware Co., NY	
Delaware County Soil & Water Conservation District	
44 West Street	
Walton, NY 13856	
Designed by	Craig J. Fischbach 6-22-06
Drawn	G. Niselle 11-6-06
Traced	S. Gladstone 11-27-06
Checked	S. Gladstone 11-27-06
Approved by	
Title	
File	
Stage	
Drawing No.	DE-C-SCMP-007

Phase I Plan View

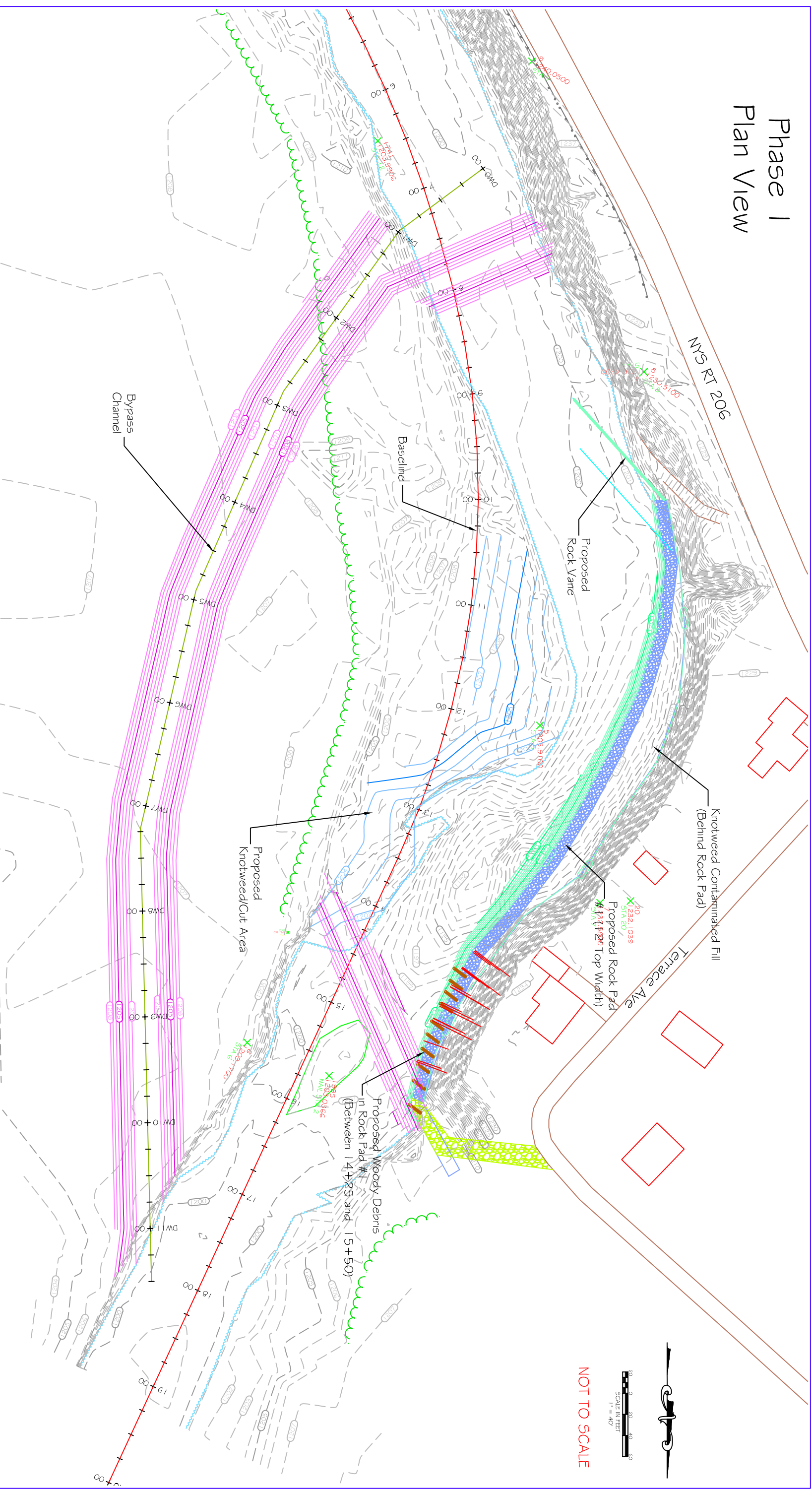

LEGEND

	Existing Contour Major		Dewatering Contour Major		Farm Road
	Existing Contour Minor		Dewatering Contour Minor		Trelline
	Phase I Contour Major		Proposed Knotweed Cut Area		Baseline
	Phase I Contour Minor		Proposed Rock Vane		Proposed Woody Debris in Rock Pad #1 (Between 14+25 and 15+50)
			Bypass Channel		Edge of Roadway

30 0 30 60
SCALE IN FEET
1" = 40'

NOT TO SCALE

Terrace Avenue As-built WBDR Restoration Phase I Plan View	
Delaware Co. Stream Corridor Management Program Delaware Co., NY	
Delaware County Soil & Water Conservation District 44 West Street Walton, NY 13056	
Designed by Craig J. Fischbach 6-22-06	Approved by
Drawn G. Nisale 11-6-06	Title
Traced	File
Checked S. Gladstone 11-27-06	Drawing No. DE-C-SCMP-007

Phase 2 Plan View

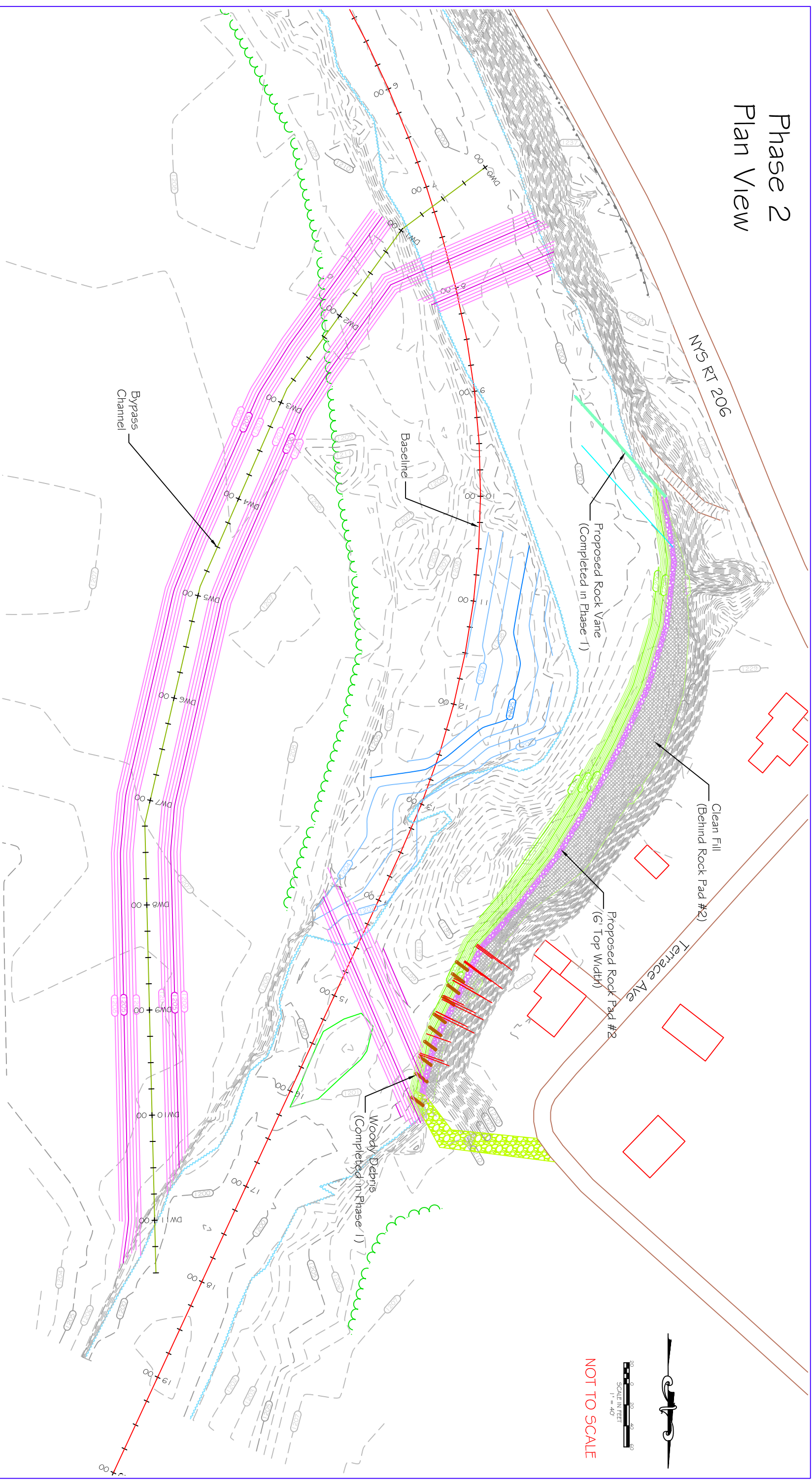

LEGEND

- Existing Contour Major
- Existing Contour Minor
- Dewatering Contour Major
- Dewatering Contour Minor
- Farm Road
- Guiderrail
- Edge of Roadway
- Treeline
- Phase 2 Contour Major
- Phase 2 Contour Minor

30 0 30 60 90
SCALE IN FEET
1" = 40'

NOT TO SCALE



Terrace Avenue As-built	
WBDR Restoration	
Phase 2 Plan View	
Delaware Co. Stream Corridor Management Program	
Delaware County Soil & Water Conservation District	
44 West Street	
Walton, NY 13856	
Designed by	Chris J. Fischbach 6-22-06
Drawn	G. Nisale 11-6-06
Traced	
Checked	S. Gladstone 11-27-06
Approved by	
File	
Stage	
Drawing No.	DE-C5CMP-007

Phase 3 Plan View

NYS RT 206

Terrace Ave

30 0 30 40 60
SCALE IN FEET
1" = 40'

NOT TO SCALE

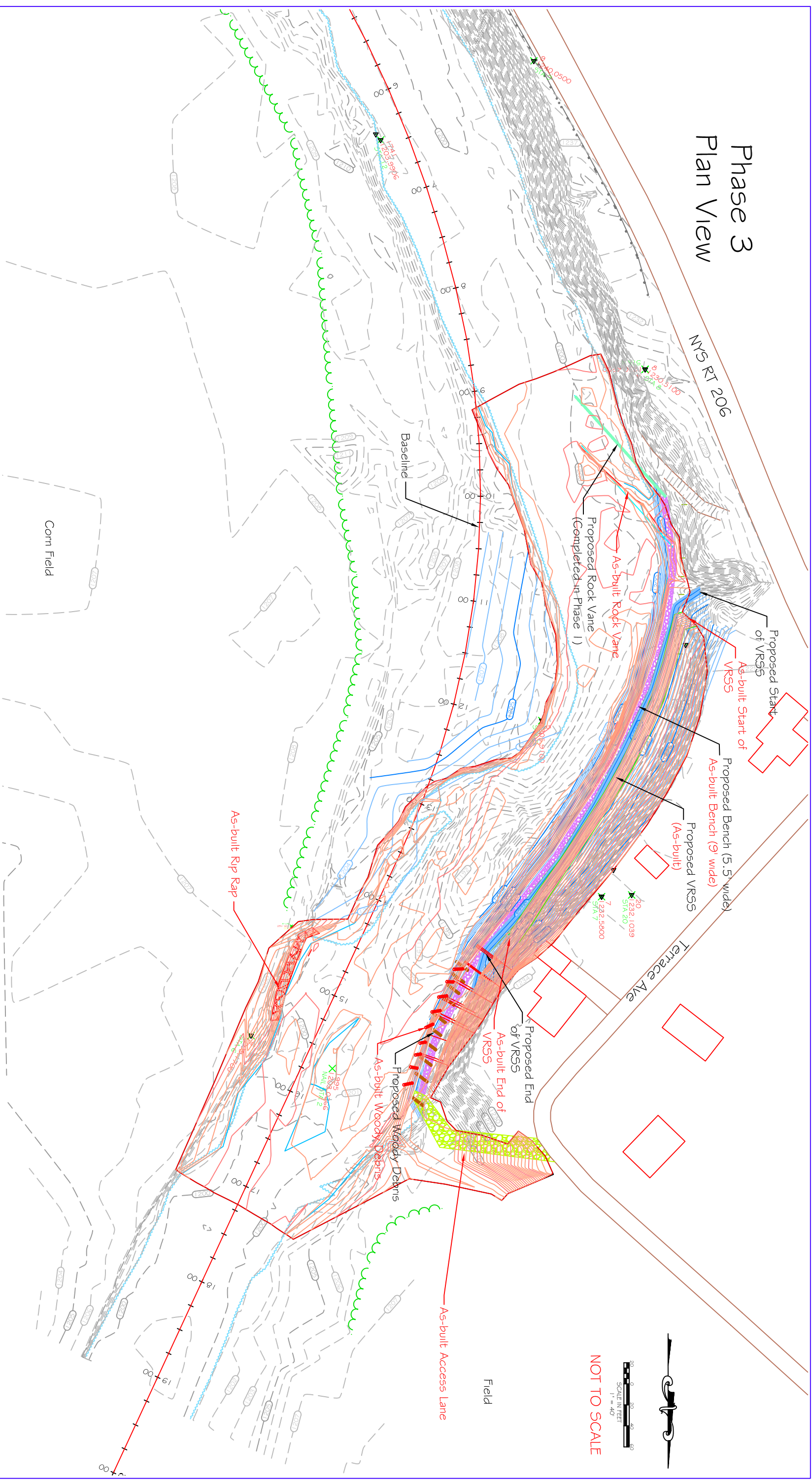

LEGEND

- | | | | | | |
|--|------------------------|--|-----------------|--|--------------------------|
| | Existing Contour | | Guidesrail | | Dewatering Contour |
| | Major Existing Contour | | Edge of Roadway | | Major Dewatering Contour |
| | Minor Existing Contour | | Treeline | | Minor Dewatering Contour |
| | Proposed Contour | | | | Proposed Riprap |
| | Major Proposed Contour | | | | |
| | Minor Proposed Contour | | | | |

Terrace Avenue As-built WBDR Restoration Phase 3 Plan View Delaware Co. Stream Corridor Management Program Delaware Co., NY	
Delaware County Soil & Water Conservation District 44 West Street Watson, NY 13056	
Designed by Craig J. Fischbach 6-22-05	Approved by G. Niselle 11-6-05
Drawn by G. Niselle 11-6-05	Checked by S. Gladstone 11-27-05
Traced by S. Gladstone 11-27-05	Drawing No. DE-C-SCMP-007

Planting Plan View

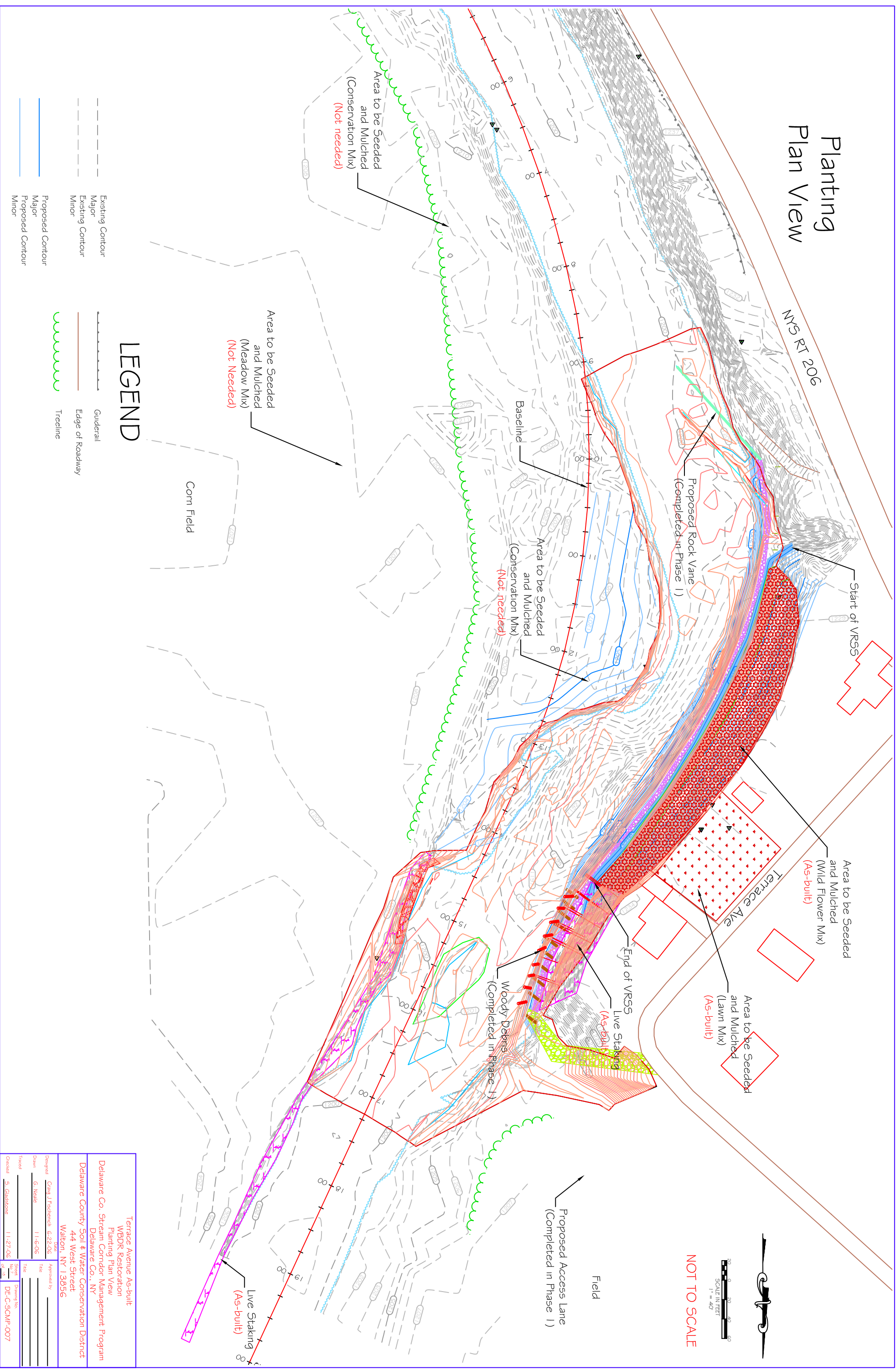







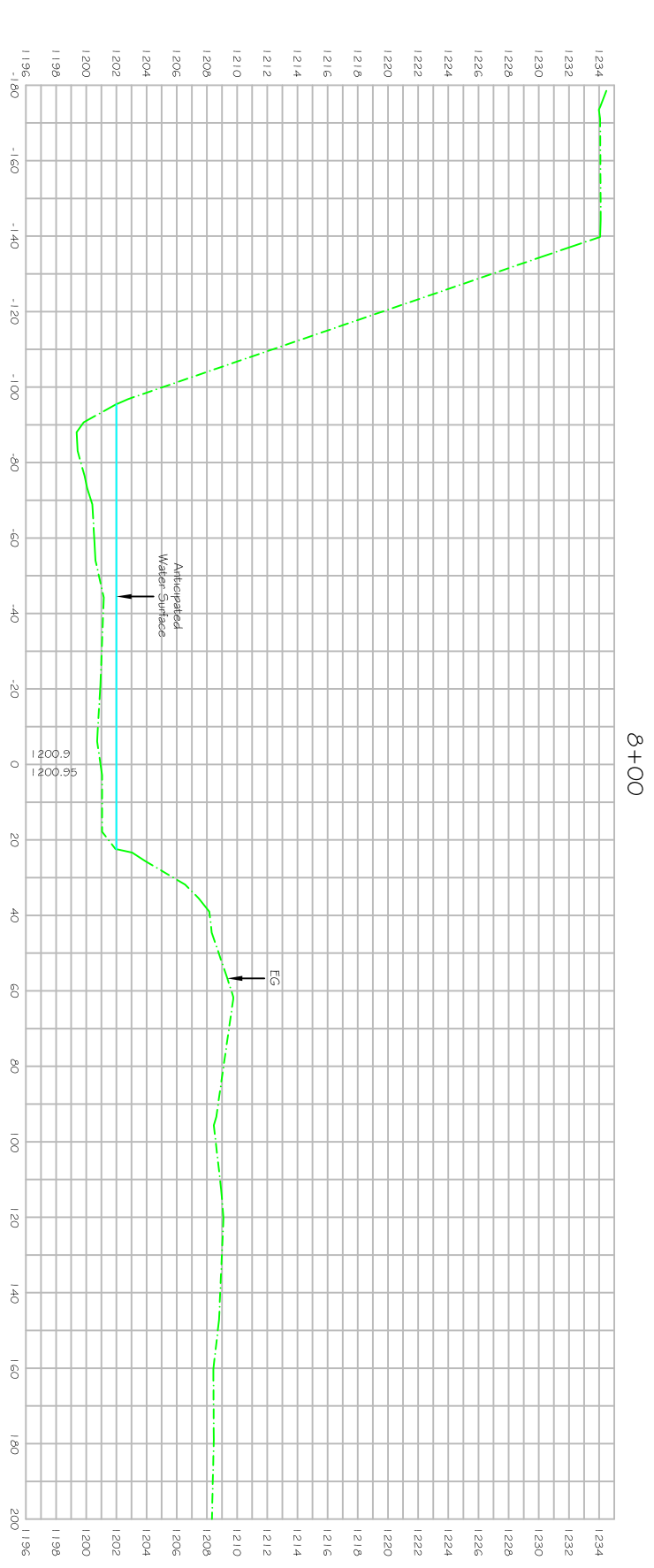
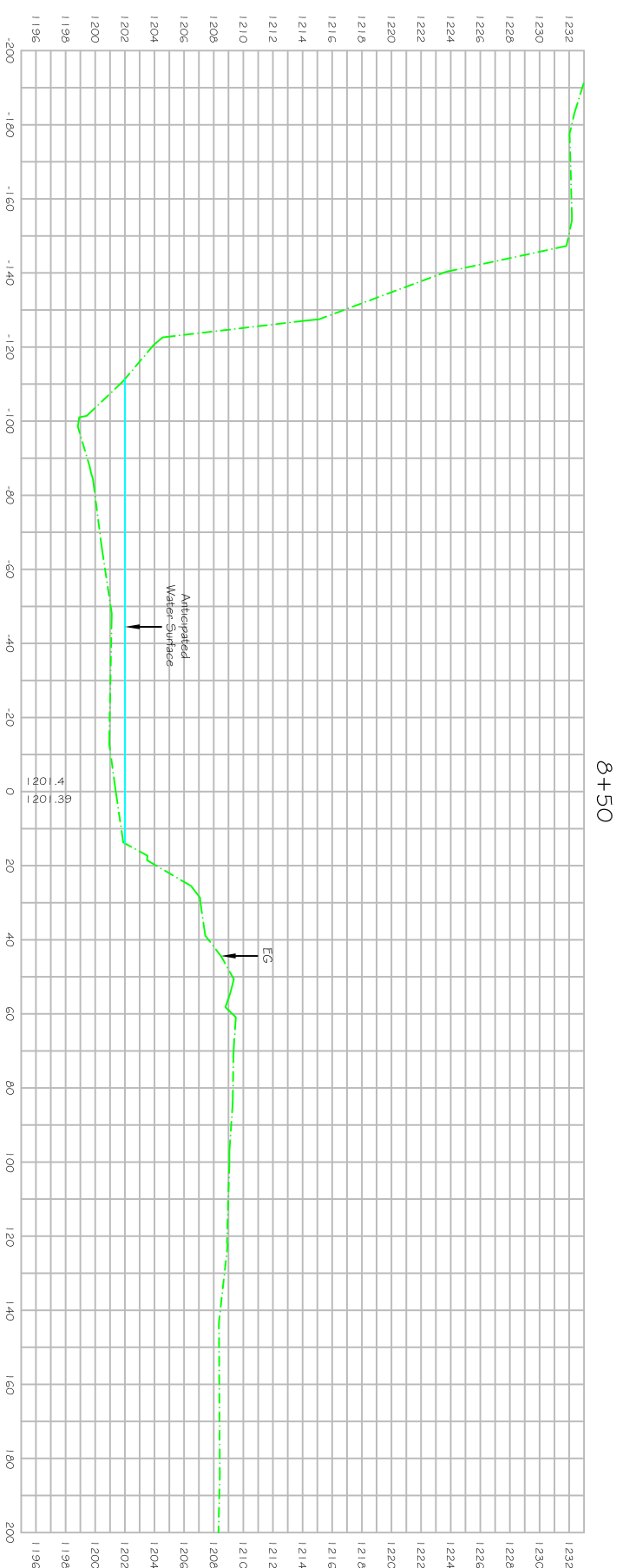

LEGEND

- Existing Contour Major
- Existing Contour Minor
- Proposed Contour Major
- Proposed Contour Minor
- Guiderrail
- Edge of Roadway
- Treeline

Terrace Avenue As-built	
WBDR Restoration	
Planting Plan View	
Delaware Co. Stream Corridor Management Program	
Delaware Co., NY	
Delaware County Soil & Water Conservation District	
44 West Street	
Walton, NY 13056	
Designed by	Craig J. Fischbach 6-22-05
Drawn by	G. Niselle 11-6-05
Checked by	S. Gladstone 11-27-05
Approved by	
File No.	
Stage	
Drawing No.	DE-C5CMP-007



LEGEND

-  Existing Ground
-  Normal Water Surface
-  Cut
-  Rock Pad #1
-  Fill #1 (Knotweed)
-  Rock Pad #2
-  Fill #2 (Onsite)
-  VR55
-  Fill #3 (Offsite)

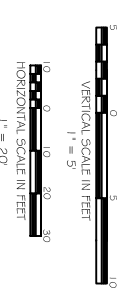

NOT TO SCALE

Terrace Ave As-built
WBDR Restoration
Cross Sections 8+00 - 8+50
Delaware Co. Stream Corridor Management Program
Delaware County Soil & Water Conservation District
Walton, NY 13056
44 West Street

Designed by Craig J. Fischbach 6-22-05	Approved by _____
Drawn G. Niselle 6-22-05	Title _____
Traced S. Gladstone 11-27-06	Scale _____
Checked S. Gladstone 11-27-06	Drawing No. DE-C-SCMP-007

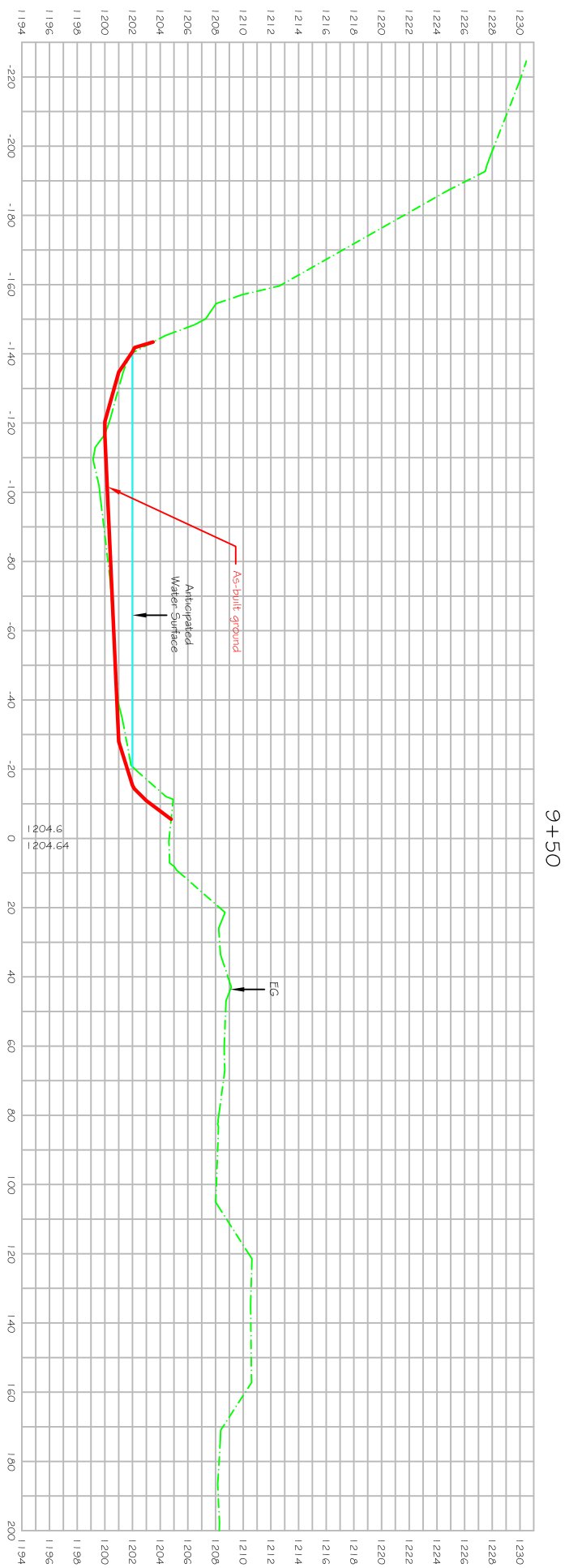



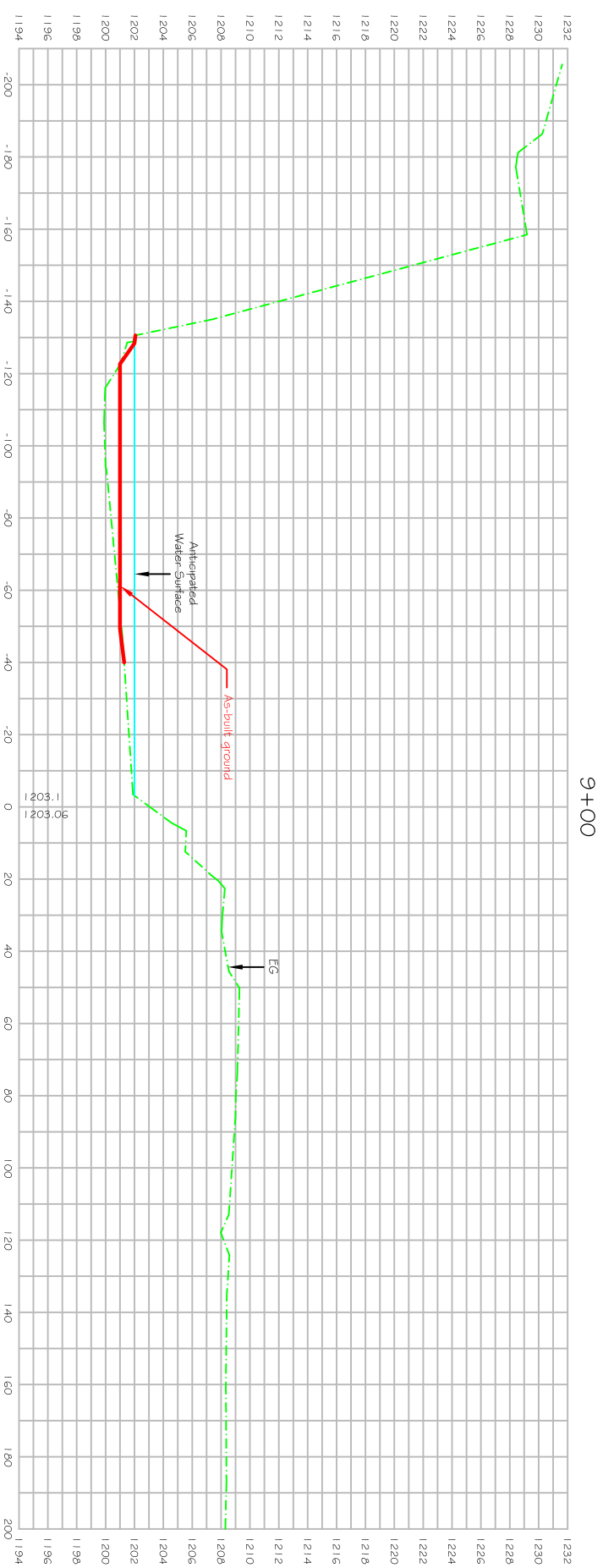





9+50



9+00

LEGEND

-  Existing Ground
-  Normal Water Surface
-  Cut
-  Rock Pad #1
-  Fill #1 (Knotweed)
-  Rock Pad #2
-  Fill #2 (Onsite)
-  VR55
-  Fill #3 (Offsite)







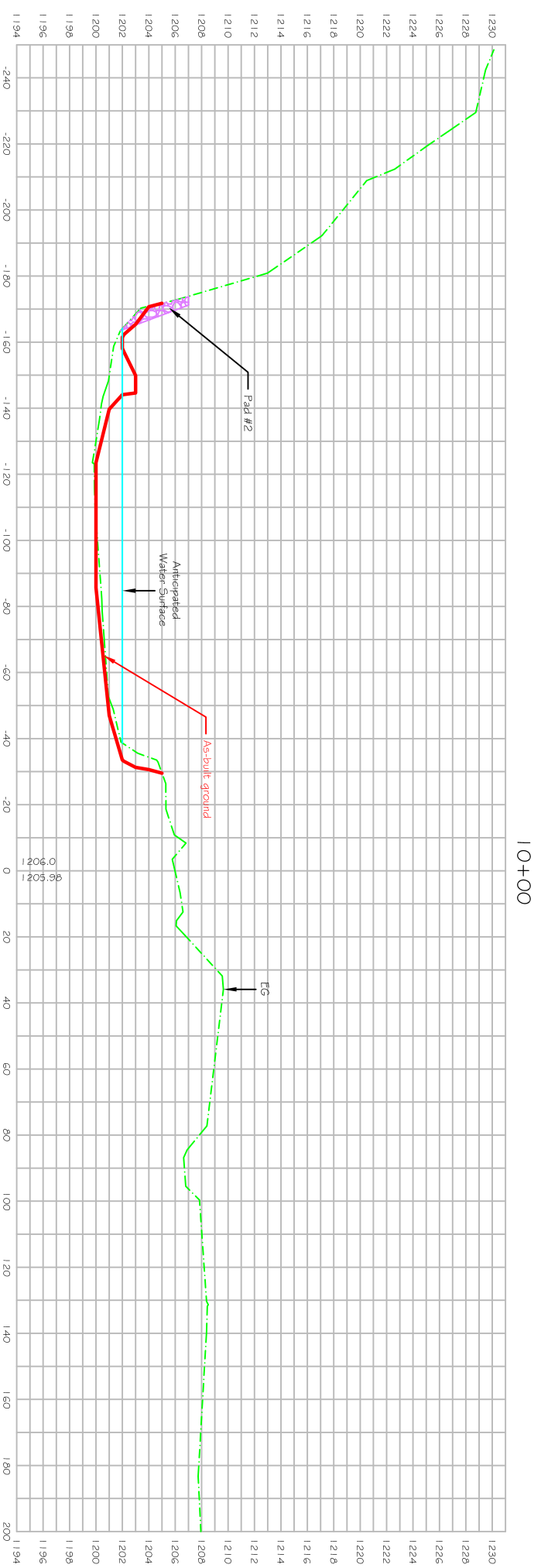
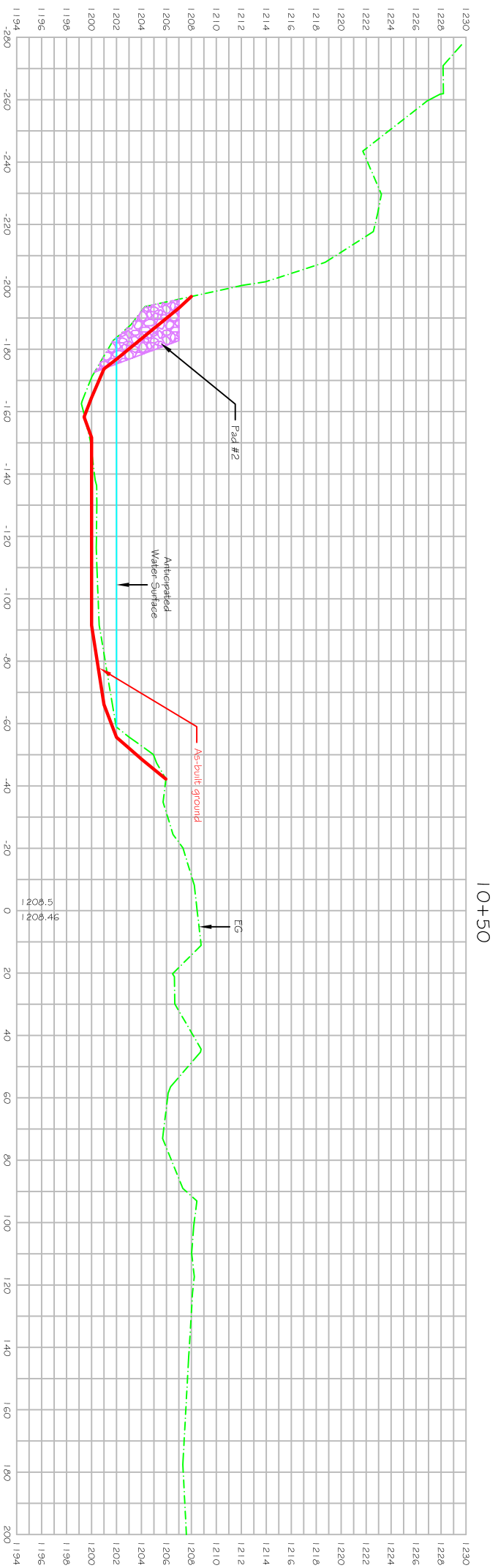



NOT TO SCALE

<p>Terrace Ave As-built WBDR Restoration Cross Sections 9+00 - 9+50 Delaware Co. Stream Corridor Management Program Delaware Co., NY</p>	
<p>Delaware County Soil & Water Conservation District 44 West Street Walton, NY 13056</p>	
<p>Designed by Craig J. Fischbach Date 6-22-05</p>	<p>Approved by _____ Title _____</p>
<p>Drawn G. Niselle Date 6-22-05</p>	<p>Checked S. Gladstone Date 11-27-05</p>
<p>Stage AS-BUILT</p>	<p>Drawing No. DE-C-SCMP-007</p>



LEGEND

-  Existing Ground
-  Normal Water Surface
-  Cut
-  Rock Pad #1
-  Fill #1 (Knotweed)
-  Rock Pad #2
-  Fill #2 (Onsite)
-  VR55
-  Fill #3 (Offsite)

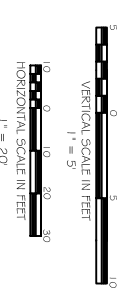

NOT TO SCALE

<p>Terrace Ave As-built WBDR Restoration Cross Sections 10+00 - 10+50 Delaware Co. Stream Corridor Management Program Delaware Co., NY</p>	
<p>Delaware County Soil & Water Conservation District 44 West Street Walton, NY 13056</p>	
<p>Designed by Craig J. Fischbach Date 6-22-05</p>	<p>Approved by Title _____ Title _____</p>
<p>Drawn by G. Niselle Date 6-22-05</p>	<p>Checked by S. Gladstone Date 11-27-05</p>
<p>Drawing No. DE-C-SCMP-007</p>	

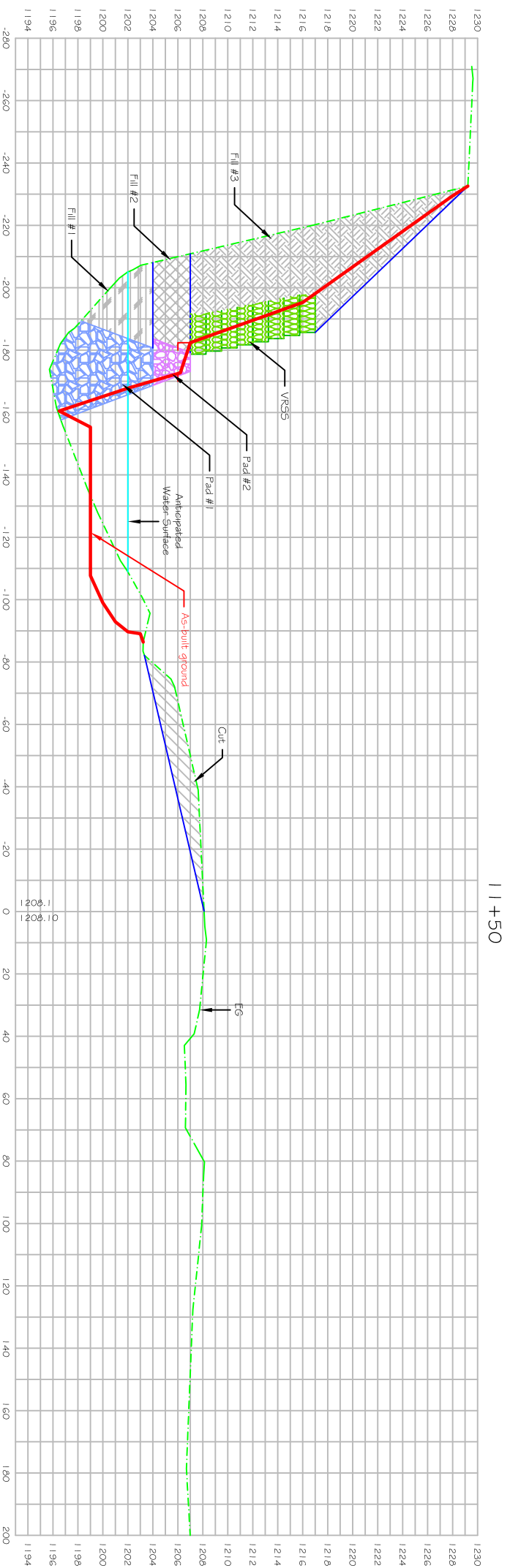

LEGEND

- Existing Ground
- Normal Water Surface
- Cut
- Rock Pad #1
- Fill #1 (Knotweed)
- Rock Pad #2
- Fill #2 (Onsite)
- VR55
- Fill #3 (Offsite)

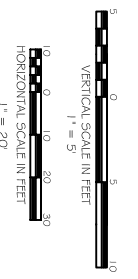
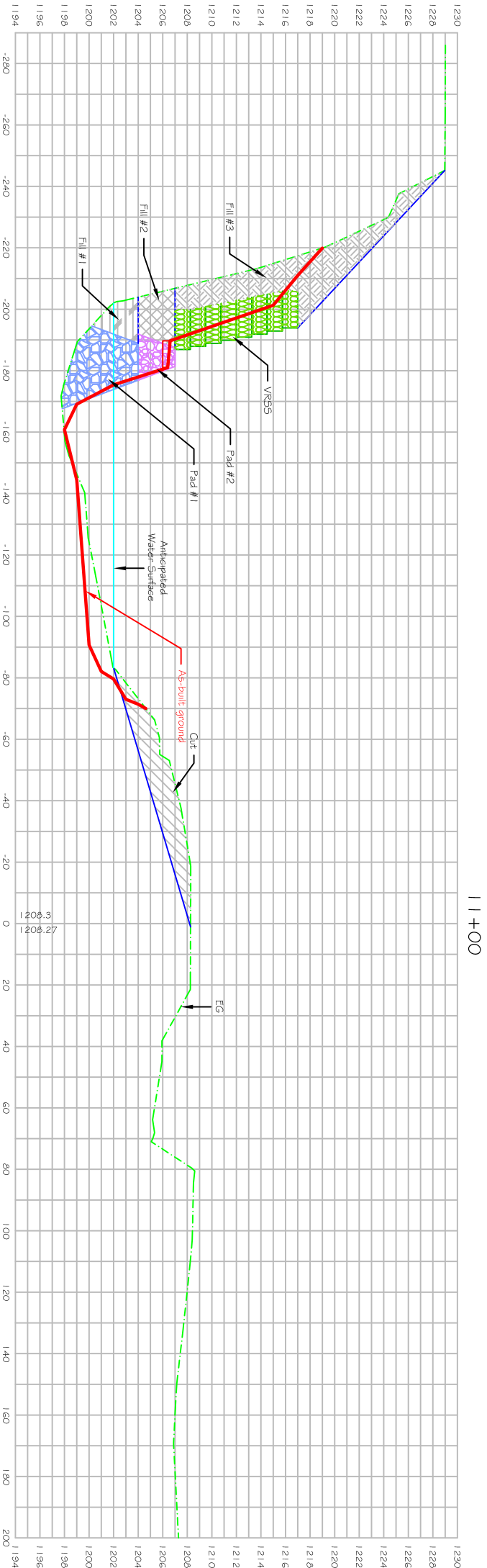

NOT TO SCALE

Terrace Ave As-built
WBDR Restoration

Cross Sections 11+00 - 11+50
Delaware Co. Stream Corridor Management Program
Delaware Co., NY

Delaware County Soil & Water Conservation District
44 West Street
Walton, NY 13056

Designed Craig J. Fischbach 6-22-05	Approved by _____
Drawn G. Niselle 6-22-05	Title _____
Traced S. Gladstone 11-27-05	Sheet _____
Checked S. Gladstone 11-27-05	Drawing No. DE-C-SCMP-007

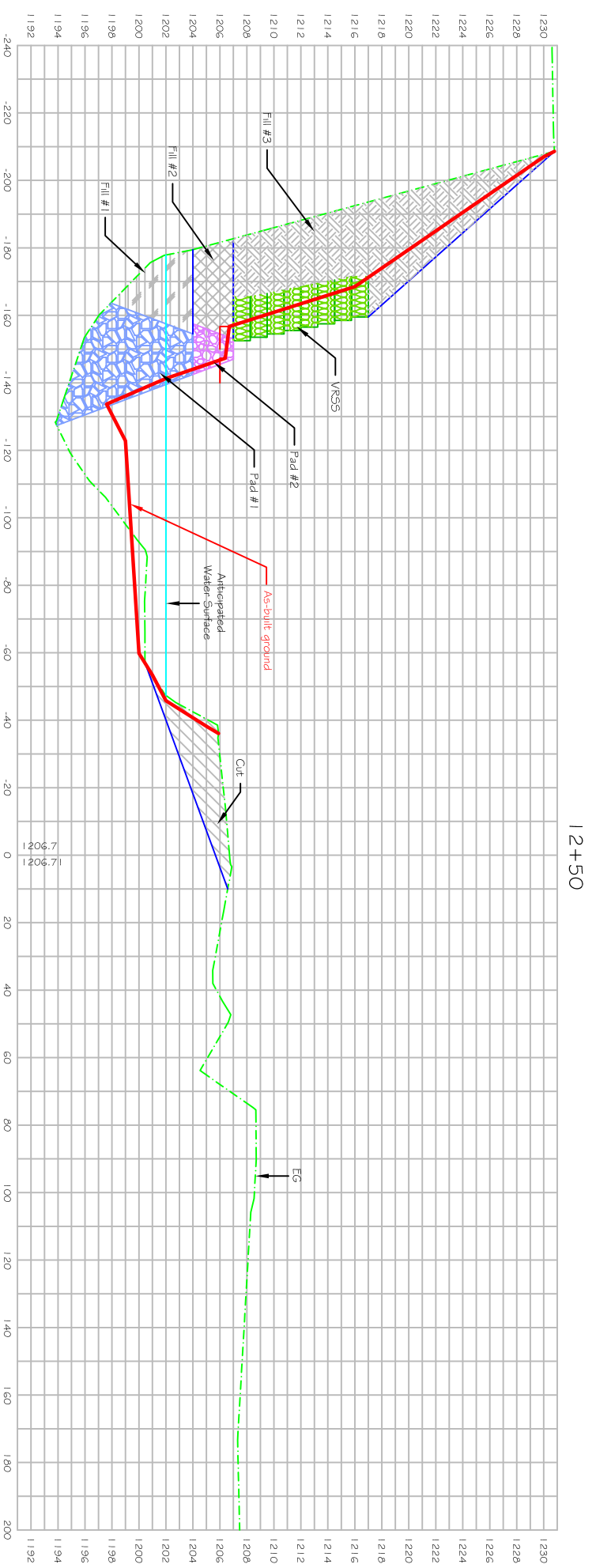



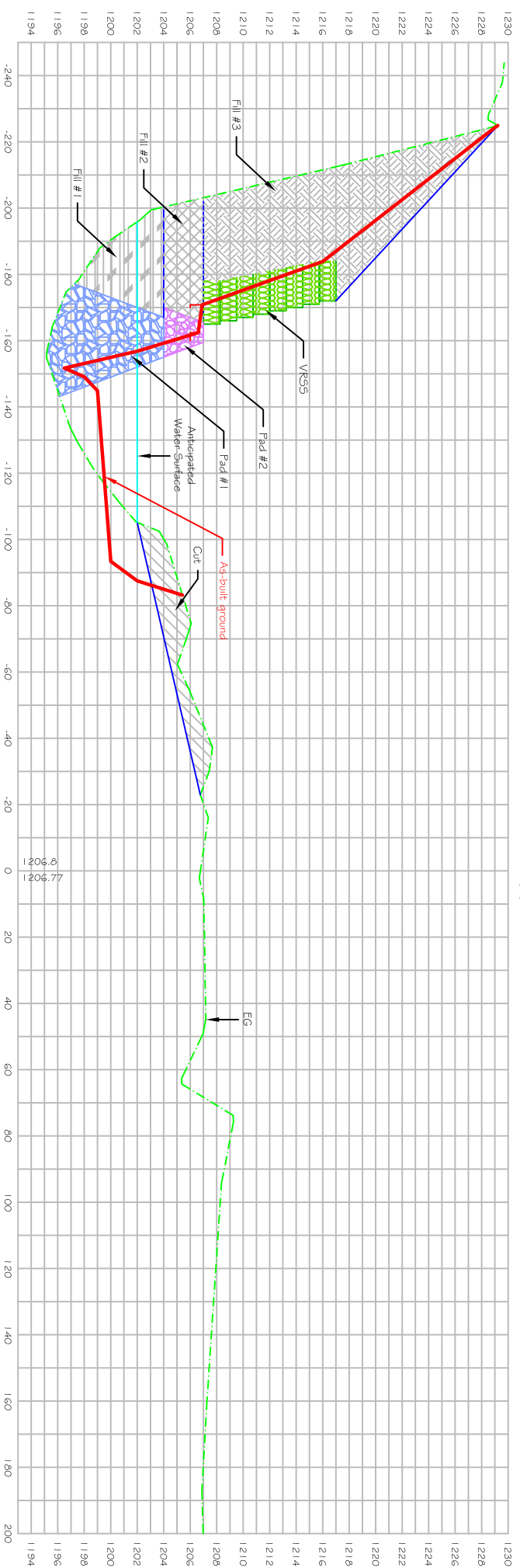





12+50



12+00

LEGEND

-  Existing Ground
-  Anticipated Water Surface
-  Cut
-  Rock Pad #1
-  Rock Pad #2
-  Fill #1 (Knotweed)
-  Fill #2 (Onsite)
-  VR55
-  Fill #3 (Offsite)



NOT TO SCALE

Terrace Ave As-built
WBDR Restoration
Cross Sections 12+00 - 12+50
Delaware Co. Stream Corridor Management Program
Delaware Co., NY

Delaware County Soil & Water Conservation District
44 West Street
Walton, NY 13056

Designed by Craig J. Fischbach 6-22-05	Approved by _____
Drawn G. Niselle 6-22-05	Title _____
Traced S. Gladstone 11-27-05	Sheet No. DE-C-SCMP-007
Checked S. Gladstone 11-27-05	Drawing No. DE-C-SCMP-007

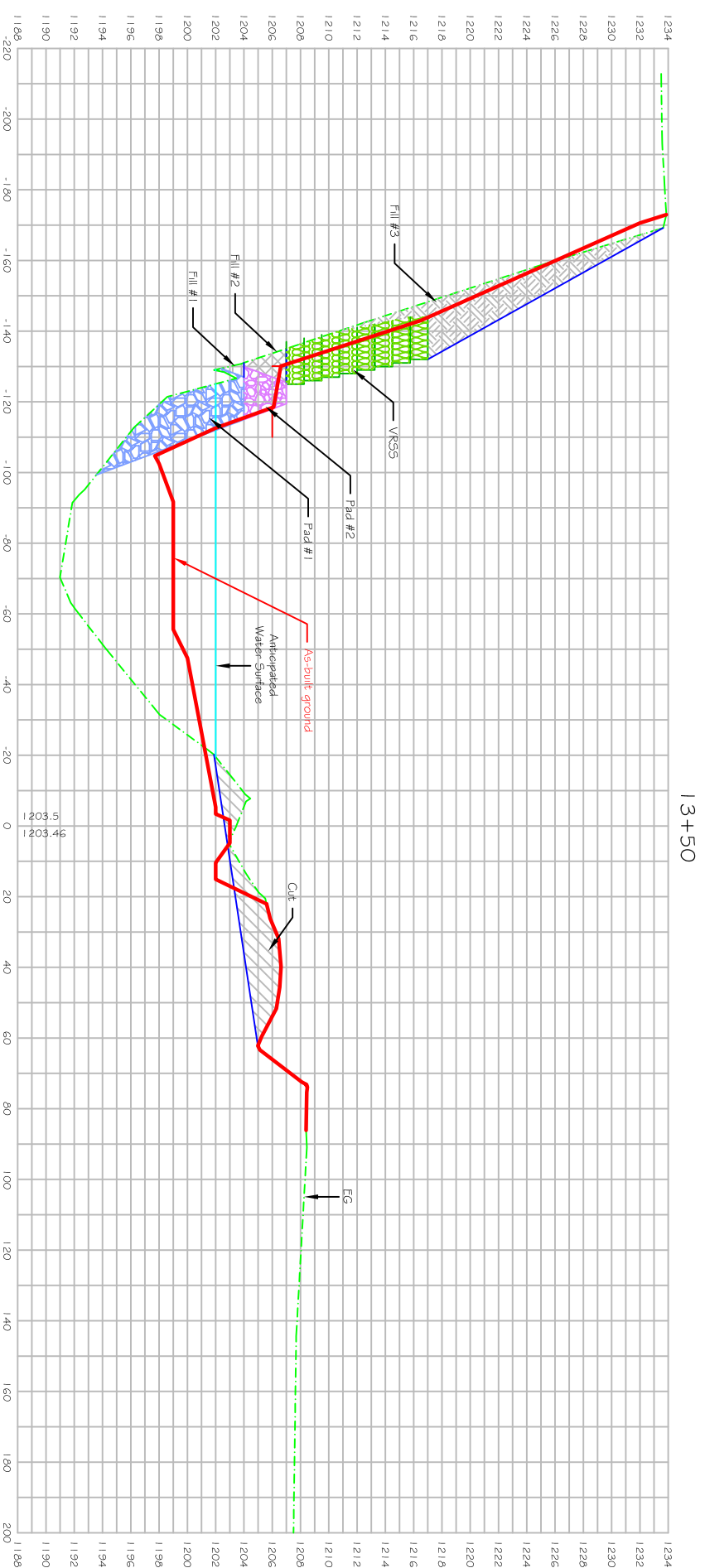









13+50



13+00

LEGEND

-  Existing Ground
-  Normal Water Surface
-  Cut
-  Rock Pad #1
-  Fill #1 (Knotweed)
-  Rock Pad #2
-  Fill #2 (Onsite)
-  VR55
-  Fill #3 (Offsite)

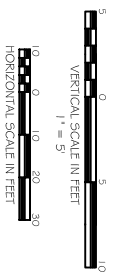

NOT TO SCALE

Terrace Ave As-built
WBDR Restoration
Cross Sections 13+00 - 13+50
Delaware Co. Stream Corridor Management Program
Delaware Co., NY
Delaware County Soil & Water Conservation District
44 West Street
Walton, NY 13056

Designed by Craig J. Fischbach Date 6-22-05	Approved by _____
Drawn G. Niselle Date 6-22-05	Title _____
Traced _____	Sheet No. _____
Checked S. Gladstone Date 11-27-05	Drawing No. DE-C-SCMP-007

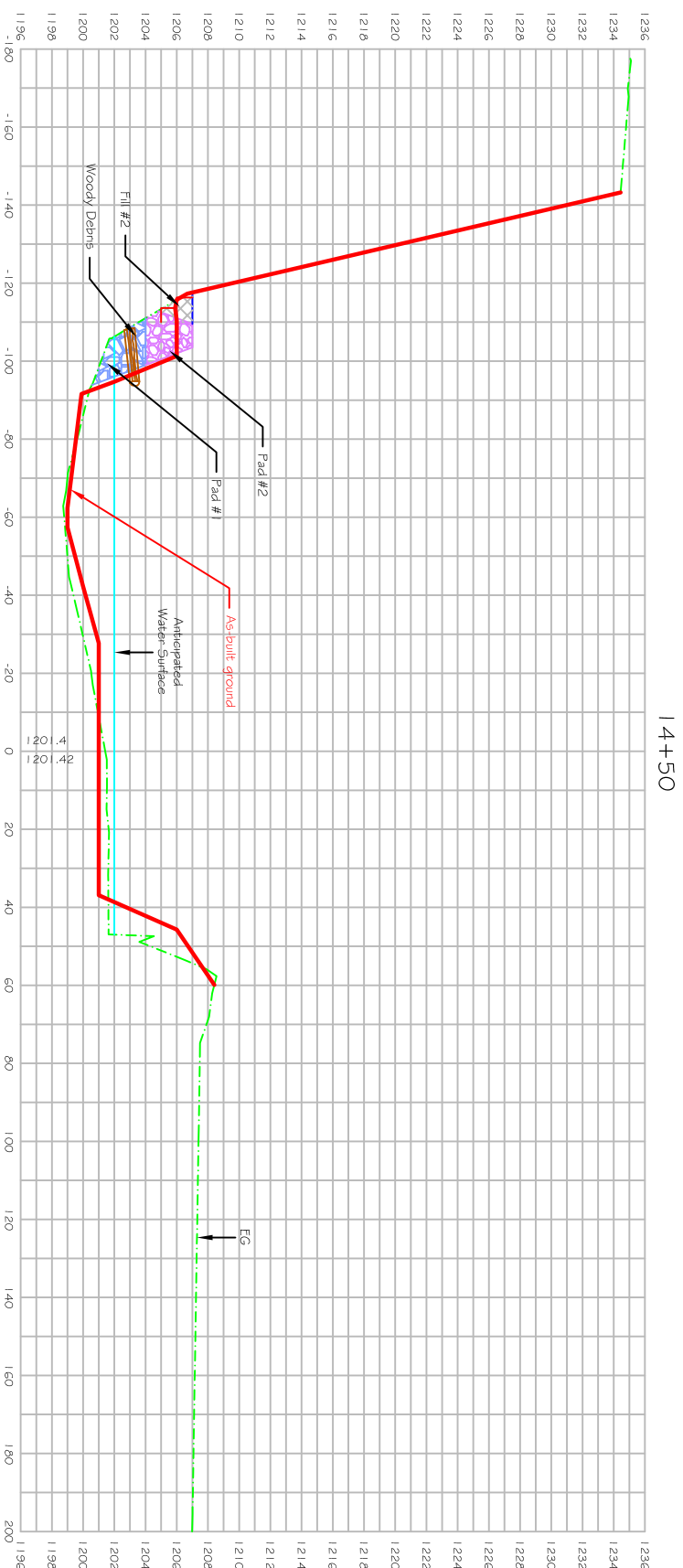

14+50

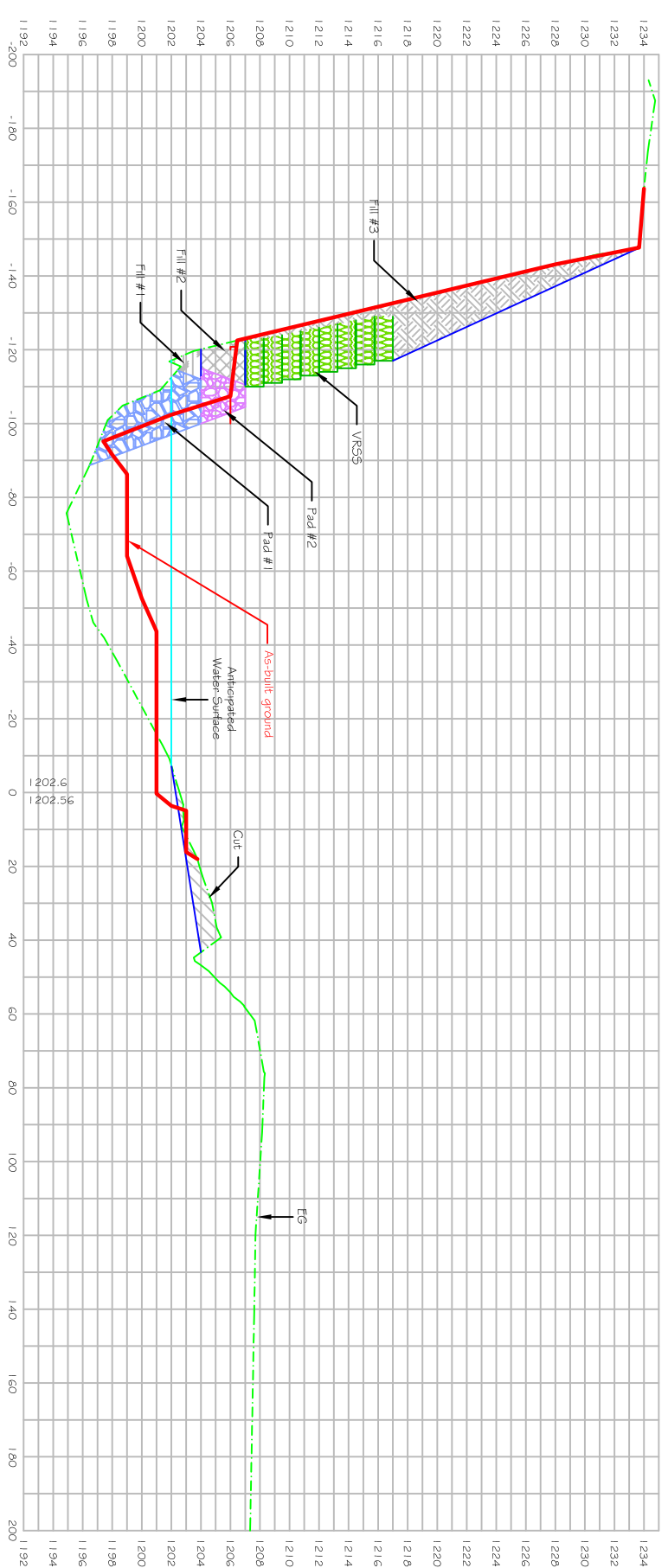

14+00

LEGEND

- - - Existing Ground
- Normal Water Surface
- Cut
- Rock Pad #1
- Fill #1 (Knotweed)
- Fill #2 (Onsite)
- VRSS
- Fill #3 (Offsite)

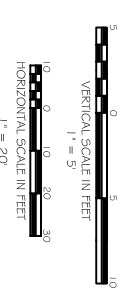





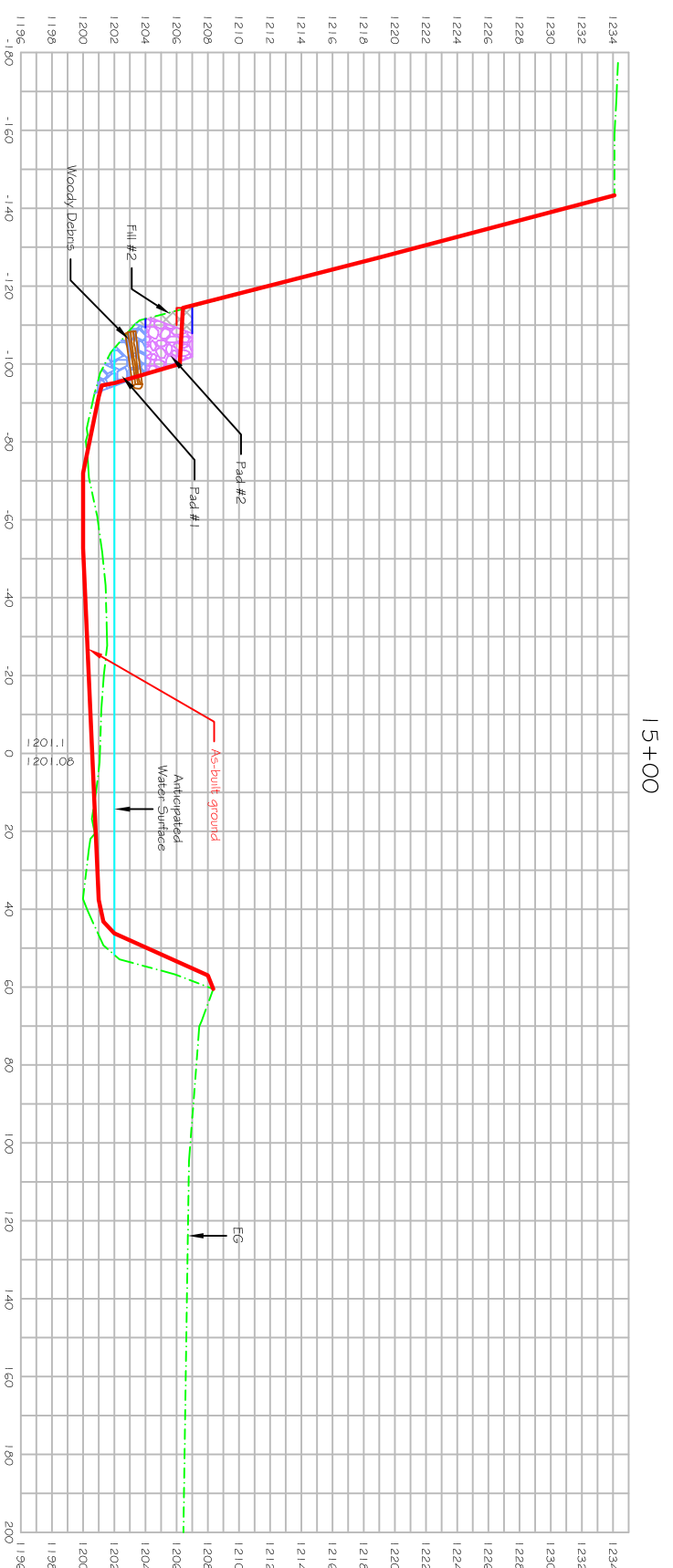
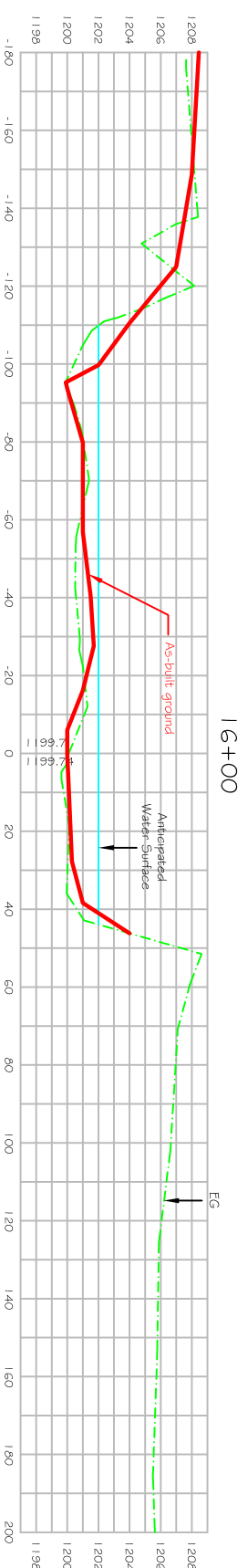



NOT TO SCALE

<p>Terrace Ave As-built WBDR Restoration Cross Sections 14+00 - 14+50 Delaware Co. Stream Corridor Management Program Delaware Co., NY Delaware County Soil & Water Conservation District 44 West Street Walton, NY 13056</p>	
<p>Designed by <u>Craig J. Fischbach</u> Date <u>6-22-05</u></p> <p>Drawn by <u>G. Niselle</u> Date <u>6-22-05</u></p> <p>Traced by <u>S. Gladstone</u> Date <u>11-27-05</u></p>	<p>Approved by _____</p> <p>Site _____</p> <p>Sheet _____</p> <p>Drawing No. <u>DE-C-SCMP-007</u></p>



LEGEND

-  Existing Ground
-  Normal Water Surface
-  Cut
-  Rock Pad # 1
-  Fill # 1 (Knotweed)
-  Rock Pad # 2
-  Fill # 2 (Onsite)
-  VR55
-  Fill # 3 (Offsite)

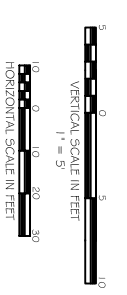

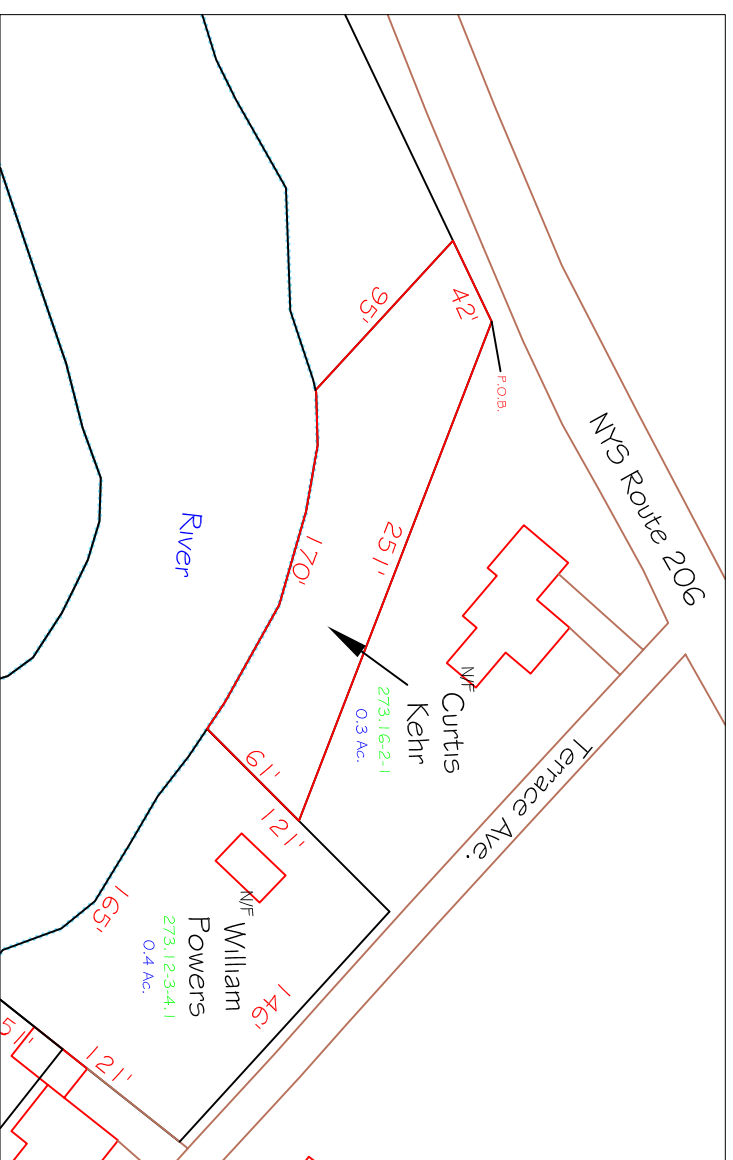
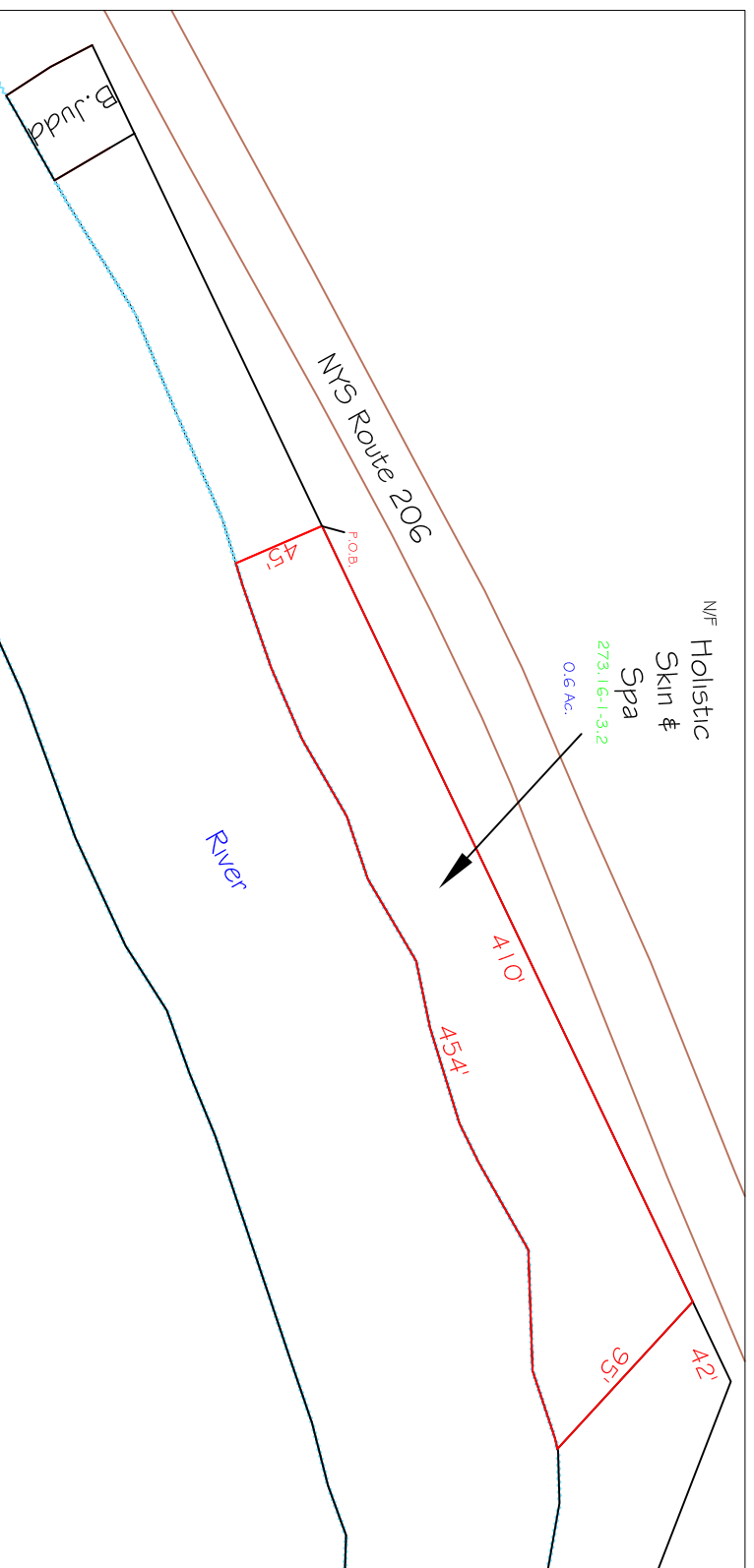

NOT TO SCALE

<p style="text-align: center;">Terrace Ave As-built WBDR Restoration Cross Sections 15+00 - 16+00 Delaware Co. Stream Corridor Management Program Delaware Co., NY Delaware County Soil & Water Conservation District 44 West Street Walton, NY 13056</p>			
Designed by	Craig J. Fischbach	Date	6-22-05
Drawn	G. Nisale	Checked	S. Gladstone
Traced		Scale	1" = 20'
Created	S. Gladstone	Drawing No.	DE-C-SCMP-007

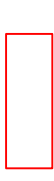

LEGEND

-  Easement Boundary
-  Existing Edge of Water
-  Edge of Roadway
-  Existing Building



20' 0 20' 40' 60'
HORIZONTAL SCALE IN FEET
1" = 40'

NOT TO SCALE



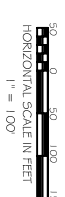
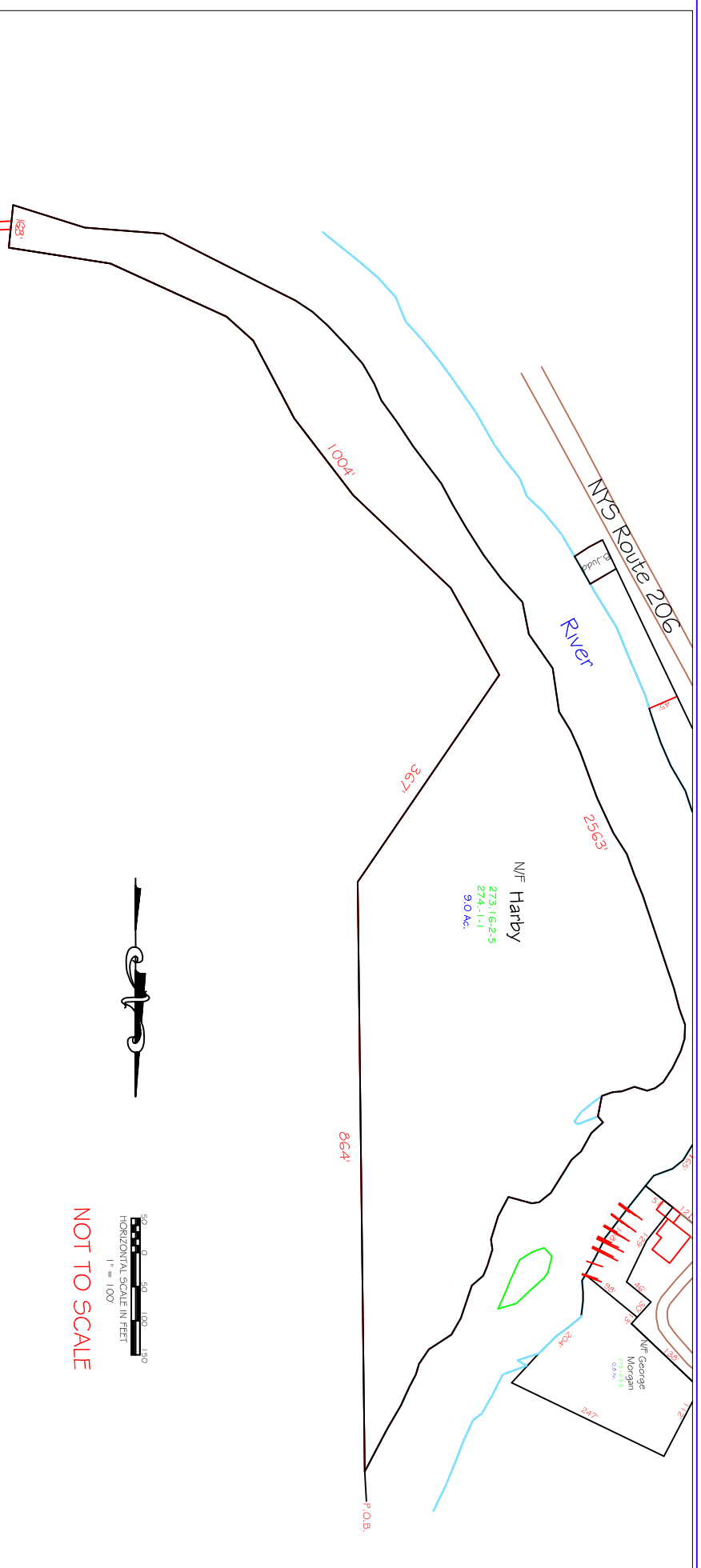

Terrace Ave As-built WBDR Restoration Easement Map #1	
Delaware Co. Stream Corridor Management Program Delaware Co., NY	
Delaware County Soil & Water Conservation District 44 West Street Walton, NY 13056	
Designed by Craig J. Fischbach 6-22-06	Approved by
Drawn by J. Fink 6-22-06	Title
Traced by S. Gladstone 11-27-06	Drawing No. DE-C-SCMP-007

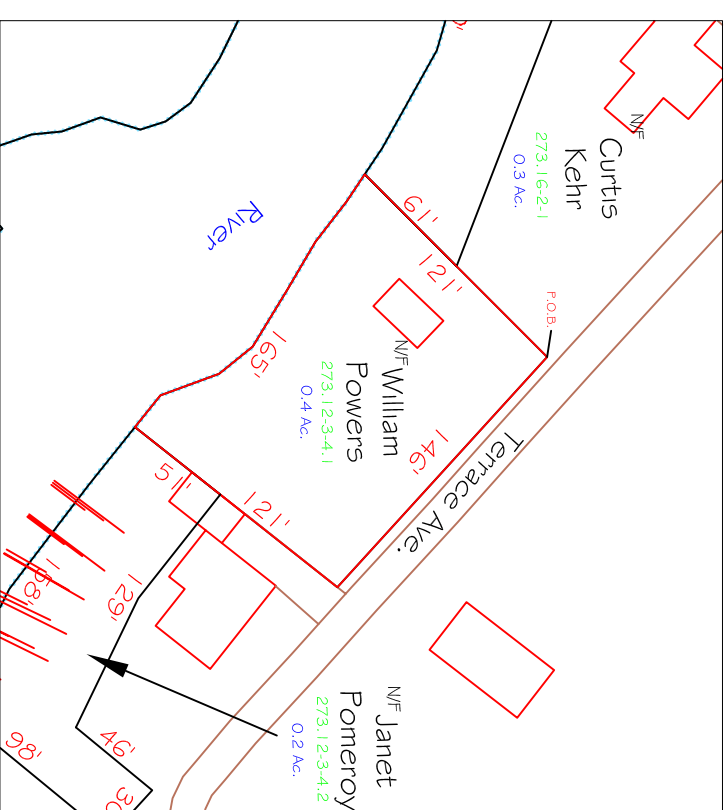
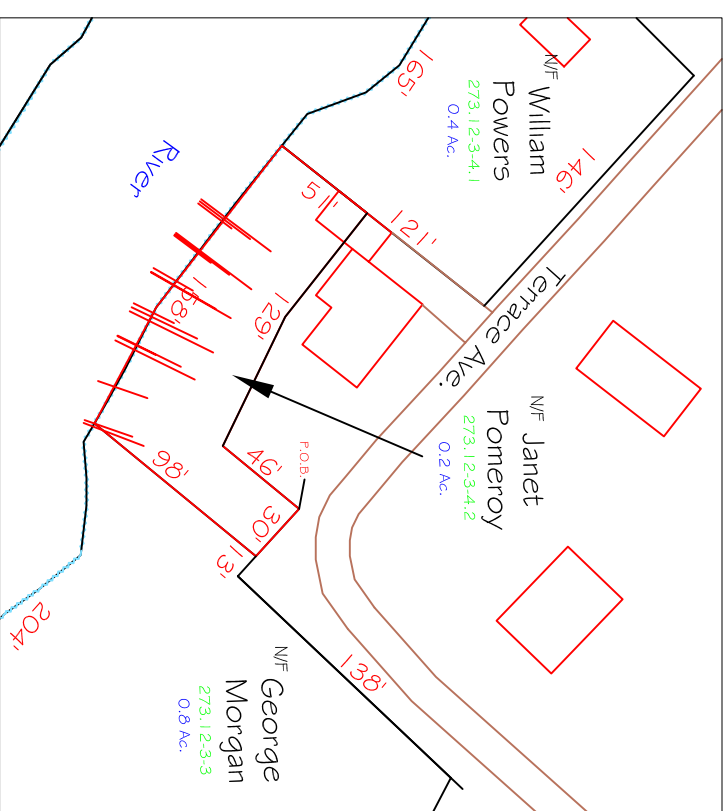
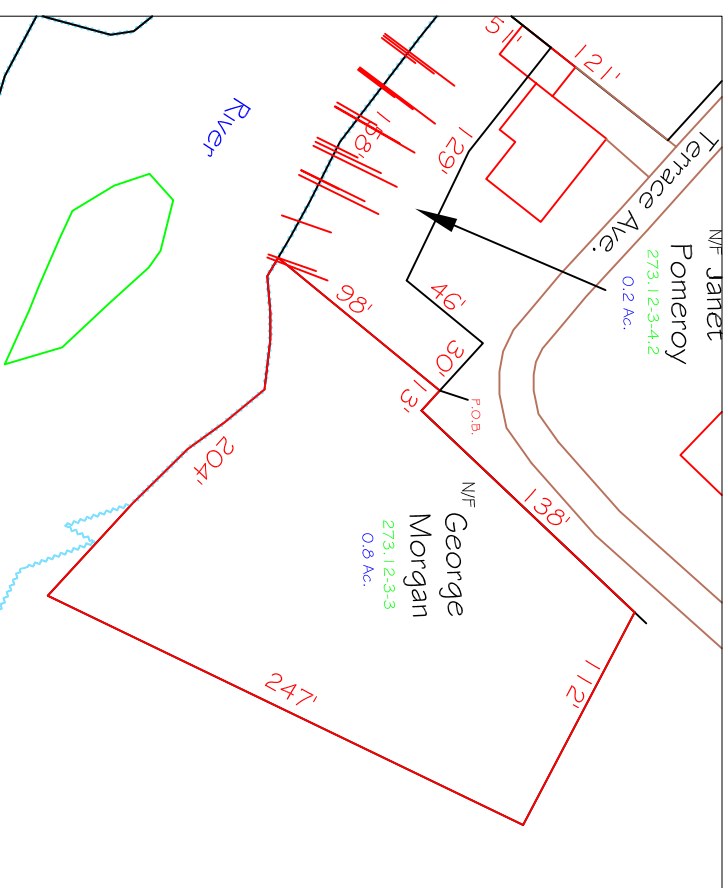

NOT TO SCALE



LEGEND

-  Easement Boundary
-  Existing Edge of Water
-  Edge of Roadway
-  Existing Building

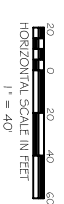

NOT TO SCALE

Terrace Ave As-built WBDR Restoration Easement Map #2 Delaware Co. Stream Corridor Management Program Delaware Co., NY	
Delaware County Soil & Water Conservation District 44 West Street Walton, NY 13056	
Designed Craig J. Fischbach 6-22-05	Approved by
Drawn J. Fink 6-22-05	Title
Traced	Sheet
Checked S. Gladstone 11-27-05	Drawing No. DE-C-5CMP-007